

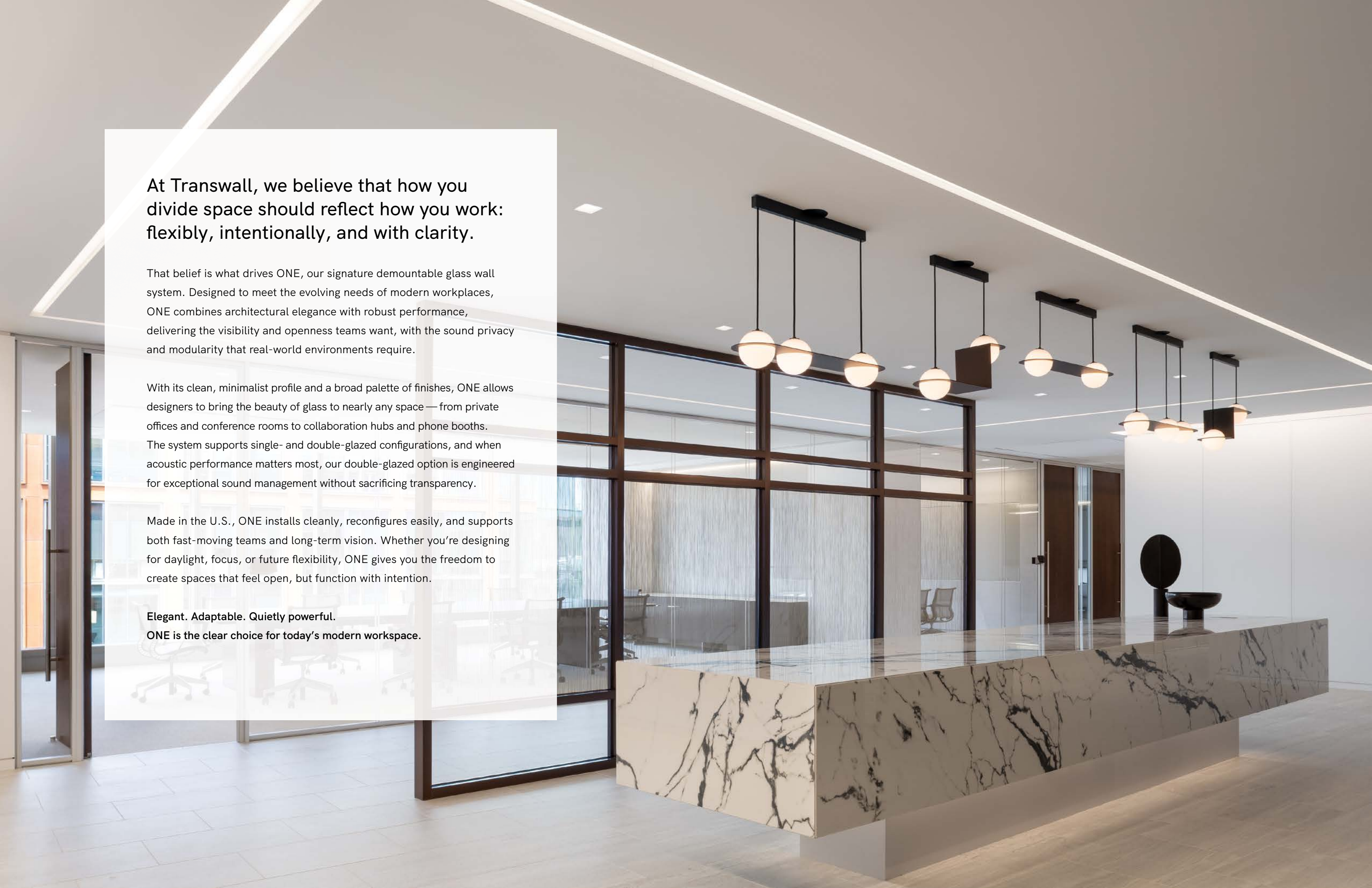

Transwall

GLASS OFFICE FRONT SYSTEM

A modern office interior featuring a long, low reception desk with a white marble top and dark base. Behind the desk is a glass-walled office space with dark frames. Several pendant lights with white globe shades hang from the ceiling. The floor is made of large, light-colored tiles. The overall design is clean and minimalist.

At Transwall, we believe that how you divide space should reflect how you work: flexibly, intentionally, and with clarity.

That belief is what drives ONE, our signature demountable glass wall system. Designed to meet the evolving needs of modern workplaces, ONE combines architectural elegance with robust performance, delivering the visibility and openness teams want, with the sound privacy and modularity that real-world environments require.

With its clean, minimalist profile and a broad palette of finishes, ONE allows designers to bring the beauty of glass to nearly any space — from private offices and conference rooms to collaboration hubs and phone booths. The system supports single- and double-glazed configurations, and when acoustic performance matters most, our double-glazed option is engineered for exceptional sound management without sacrificing transparency.

Made in the U.S., ONE installs cleanly, reconfigures easily, and supports both fast-moving teams and long-term vision. Whether you're designing for daylight, focus, or future flexibility, ONE gives you the freedom to create spaces that feel open, but function with intention.

Elegant. Adaptable. Quietly powerful.

ONE is the clear choice for today's modern workspace.



ONE SYSTEM INSTALLED IN WASHINGTON, DC

ONE System. Infinite Possibilities.

The beauty of the ONE system lies in its versatility. Built to adapt to your space and your vision, ONE gives you complete freedom to configure a glass wall system that’s as functional as it is refined. Choose from a wide range of glazing options, glass types, profiles, doors, finishes, and accessories to craft the perfect combination for your environment, whether you’re designing for openness, privacy, acoustics, or all of the above. With ONE, the components work seamlessly together so you can focus on creating a space that’s entirely your own.

INTRO TO THE ONE SYSTEM	2
GLAZING CONFIGURATIONS	10
GLASS TYPES	28
TRIM OPTIONS	30
DOORS	32
CONNECTORS + CORNERS	42
ACCESSORIES + ENHANCEMENTS	52
HARDWARE	56
PERFORMANCE + COMPLIANCE	68
STATEMENT OF LINE	72
CONTACT + PROJECT PLANNING	78



Transwall: Where American Craftsmanship Meets Modern Design

All of Transwall’s systems are designed, engineered, and manufactured at our 85,000 sq. ft. facility in West Chester, Pennsylvania. By keeping every step of production under one roof, we ensure unmatched quality, faster turnaround times, and greater control over every detail.

- CNC Metal Fabrication – Precision engineering for custom and complex profiles.
- Low-VOC Powder Coating – Environmentally friendly finishes with custom color capability.
- >90% U.S.-Sourced Materials – Optimized delivery and minimized tariff risks.
- Local glass sourcing to reduce transportation costs and environmental impact
- 100% U.S. manufactured aluminum from domestic extrusion stock
- Full In-House Production – From metal fabrication to finishing, all manufacturing happens on site for consistent quality and responsive lead times.

For more than 60 years, our West Chester headquarters has been the foundation of Transwall’s reputation for excellence—delivering American-made products backed by American craftsmanship.



Metal Shop

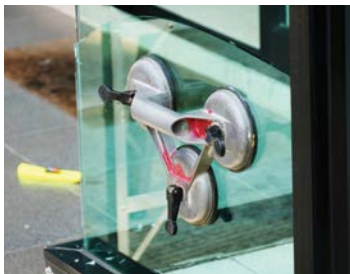

Assembly



CNC Machining



In-House Powder Coat Paint System

Project Management You Can Trust

At Transwall, great products are only part of the story. What truly sets us apart is our dedicated project management team. From the first conversation to post-installation support, our experts ensure your project is delivered seamlessly, on time, and on budget.

- **Pre-Sales Guidance:** Helping clients identify the right solution for their space.
- **Engineering & CAD Support:** Turning ideas into precise, buildable realities.
- **In-House Fabrication Oversight:** Coordinating production for speed and quality control.
- **Installation Supervision:** Certified local installers, supported by on-site Transwall supervisors.
- **Post-Installation Care:** Service plans, upgrades, and long-term support keep systems performing for years to come.

With more than six decades of experience, Transwall’s project managers are not just coordinators—they are partners in your success, ensuring every installation reflects our promise of performance, quality, and attention to detail.

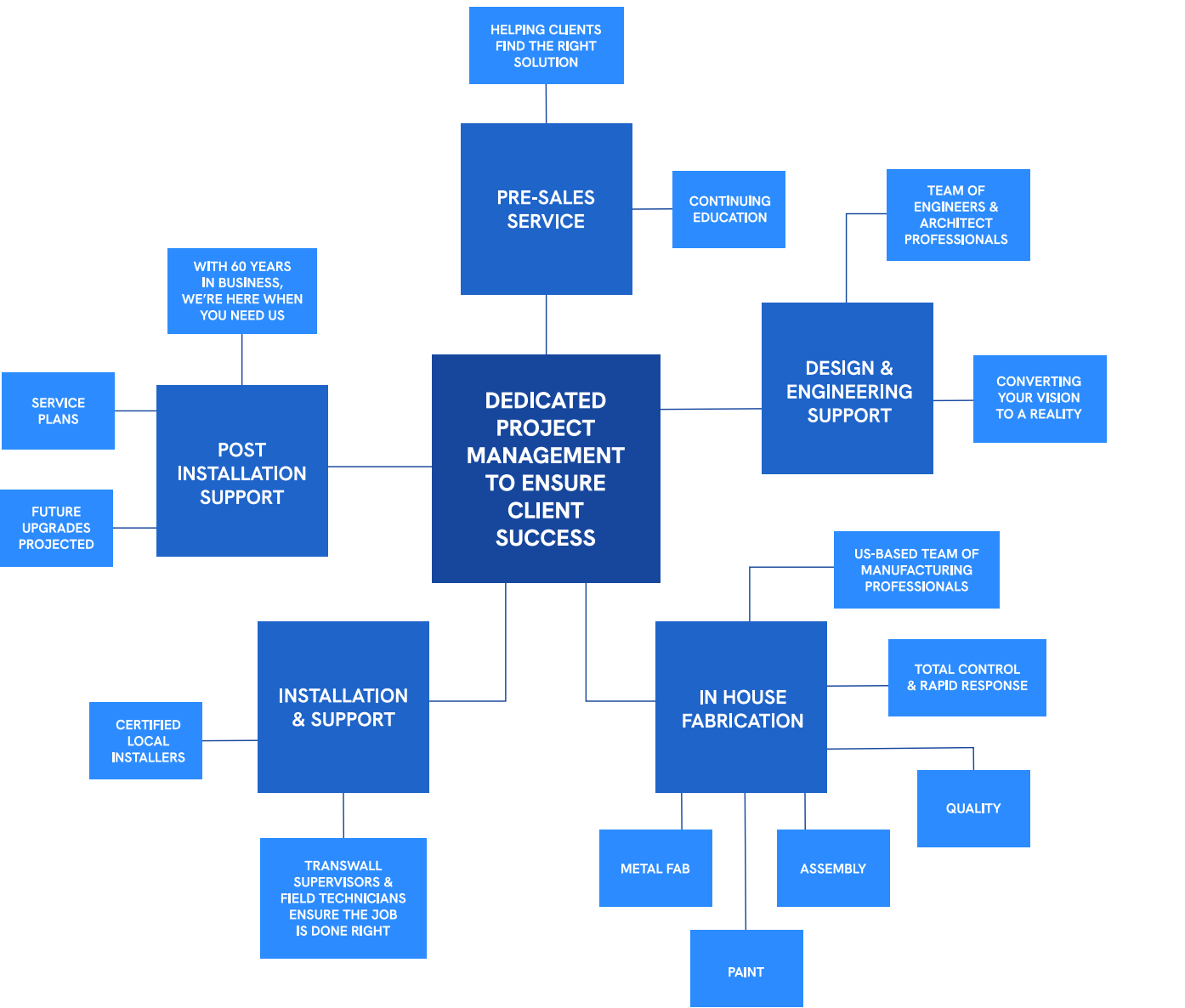

GLAZING CONFIGURATIONS

The Transwall ONE system offers a variety of glazing configurations designed to balance aesthetics, performance, and design flexibility. Whether the priority is sound control, visual alignment, or creating architectural impact, each configuration provides distinct advantages to meet project needs.

SINGLE-GLAZED

Available in both Center-Glazed (SP + LP) and Offset-Glazed (LP) options, single-glazed walls deliver a refined, minimalist appearance while supporting acoustic performance up to STC 37.

Center-Glazed (1/2"): Provides a balanced, symmetrical look from both sides with clean lines.

Offset-Glazed (1/2"): Moves the glass toward the exterior face, allowing single- and double-glazed walls to visually align from the corridor side—ideal for blending high-privacy and lower-privacy spaces within one design.

DOUBLE-GLAZED (LP ONLY)

Double-glazed walls feature two panes of glass for superior acoustic control, making them the best choice for private offices, conference rooms, or focus areas. With STC ratings up to 45, they provide maximum privacy while maintaining a refined design.

CURVED GLASS

Curved walls are available in single- or double-glazed formats, adding architectural interest and fluidity while maintaining acoustic performance and design continuity.



SINGLE-GLAZED: CENTER OR OFFSET



CENTER-GLAZED

FRAME DIMENSIONS	Standard Profile: 3.12"W x 2.5" to 3.5"H Low Profile: 3.125"W x 1.5"H
PANEL OPTIONS	Single Center-Glazed, Single Offset-Glazed
MAXIMUM GLASS SIZE	10'H, 42"W (other sizes available, project specific), Wall heights up to 12' with transom windows
LEVELING TOLERANCE	Standard Profile: +/- 3/4" Low Profile: +/- 1/2"
CEILING CONNECTION	Standard Profile: Soffit & ACT Installation Low Profile: Soffit Installation Only
GLAZING	Standard Profile: 1/2" Tempered and Laminated & 1/2" Low Profile: 1/2" Tempered, 1/2" Low Iron, 1/2" Acid-Etched Glass, Clear Polycarbonate Glazing Channel

DOOR OPTIONS	Single-Glazed Frameless Sliding & Pivot, Single-Glazed Framed Sliding & Pivot, Double-Glazed Framed Sliding & Pivot, Veneer/Painted Wood Sliding & Pivot
HARDWARE	Locking and Non-locking Ladder Pulls, Cylindrical & Mortise Locksets, Offset Pivot Hinges, Roller Hardware
FINISHES	Standard Profile: Powder Coat Paint (custom colors available) Low Profile: Polished & Anodized Aluminum, Powder Coat Paint (custom colors available)
STC	34-37
LEAD TIME	4-6 weeks after receipt of approved shop drawings and field measurements
MANUFACTURING LOCATION	West Chester, Pennsylvania, USA



OFFSET-GLAZED

DOUBLE-GLAZED



DOUBLE-GLAZED

LOW PROFILE FRAME DIMENSIONS	3.125"W x 1.5"H
PANEL STYLE	Double-glazed
MAXIMUM GLASS SIZE	10'H, 42"W (other sizes available, project specific)
LEVELING TOLERANCE	+/- 1/2"
CEILING CONNECTION	Soffit Installation
GLAZING	1/2" Tempered, 1/2" Low Iron, 1/2" Acid-Etched Glass, Clear Polycarbonate Glazing Channel

DOOR OPTIONS	Single-Glazed Frameless Sliding & Pivot, Single-Glazed Framed Sliding & Pivot, Double-Glazed Framed Sliding & Pivot, Veneer/Painted Wood Sliding & Pivot
HARDWARE	Locking and Non-locking Ladder Pulls, Cylindrical & Mortise Locksets, Offset Pivot Hinges, Roller Hardware
FINISHES	Polished & Anodized Aluminum, Powder Coat Paint (custom colors available)
STC	Up to 45
LEAD TIME	4-6 weeks after receipt of approved shop drawings and field measurements
MANUFACTURING LOCATION	West Chester, Pennsylvania, USA



CURVED GLASS

Transwall's ONE system isn't limited to straight walls—its modular panels can be arranged to create fluid, curved glass partitions. This design-forward layout preserves the system's sleek profile and acoustic performance while introducing sculptural elegance to your space.

SYSTEMS PROFILE

Choose between two distinct design profiles to match your project’s needs — whether you’re maximizing acoustic performance or minimizing visual impact. We have the solution that fits your space, without compromising on quality.

SPECIFICATIONS

	STANDARD PROFILE	LOW PROFILE
FRAME DIMENSIONS	3.125" x 3" nominal (2 5/16 - 3 13/16)	3.125"W x 1.5" H
GLAZING OPTIONS	Single Center-Glazed	Single Center-Glazed, Offset, Double
MAXIMUM GLASS SIZE	10'H, 42"W (other sizes available, project specific), Wall heights up to 12' with transom windows	
LEVELING TOLERANCE	+/- 3/4" for Panels, +/- 1/2" for doors	+/- 1/2"
CEILING CONNECTION	Soffit & ACT Installation	Soffit Installation Only
GLASS TYPE	1/2" Tempered Monolithic, 1/2" Low Iron	1/2" Tempered, 1/2" Low Iron, 1/2" Annealed Laminated, 1/2" Architectural glass (covers acid etched and other types)
FINISHES	Powder Coat Paint (custom colors available)	Polished & Anodized Aluminum, Powder Coat Paint (custom colors available)
DOOR OPTIONS	Single-Glazed Frameless Sliding & Pivot, Single-Glazed Framed Sliding & Pivot, Double-Glazed Framed Sliding & Pivot, Veneer/Painted Wood Pivot	
HARDWARE	Locking and Non-locking Ladder Pulls, Cylindrical & Mortise Locksets, Offset Pivot Hinges, Roller Hardware	
STC	34	34-45
LEAD TIME	4-6 weeks after receipt of approved shop drawings & field measurements	
MANUFACTURING LOCATION	West Chester, Pennsylvania, USA	



ONE VS. ONE LP

Both the ONE and ONE LP systems deliver the same architectural language and premium performance, but each brings a distinct design expression to your space.

Whether you want a bold statement or a subtle edge, both options allow you to achieve the right balance of design and performance for your project.

ONE

A bold, full-profile frame that provides a strong architectural presence and design versatility. Ideal for environments where framing is part of the visual statement, ONE balances aesthetics with functionality for a timeless look.

ONE LP (Low Profile)

A sleek, minimalist frame that creates a nearly invisible edge, maximizing glass and light while minimizing the visual impact of framing. Perfect for modern environments that prioritize openness, clarity, and a refined appearance.



Low Profile



Standard Profile



Low Profile



Standard Profile

SOUND CONTROL

Why Sound Control Matters

Noise in the workplace is one of the most common sources of distraction, lowering productivity and focus. Studies show that improving the acoustic environment can enhance visual cognitive performance and overall employee well-being.

Transwall designs wall systems that help create quieter, more productive spaces. Whether you need privacy for focused work, collaboration zones, or confidential meeting rooms, our solutions let you balance performance, aesthetics, and budget.



How Is Sound Is Measured?

Three main ratings are used to measure sound blocking:

- STC (Sound Transmission Class): A laboratory measurement that isolates how much sound passes through a single wall or partition.
- FSTC (Field Sound Transmission Class): A field measurement that accounts for real-world conditions, including sound that may leak through ceilings, floors, ductwork, and other building elements.
- NIC (Noise Isolation Class): Another field measurement that provides an overall indication of how well two rooms are acoustically separated.

Because FSTC and NIC account for all the noise pathways, results are typically 5-10 points lower than the lab STC rating. This is normal and highlights the importance of good design and installation practices.

STC Ratings in Practice (Visualized)
SUBJECTIVE DESCRIPTION OF EFFECTIVENESS

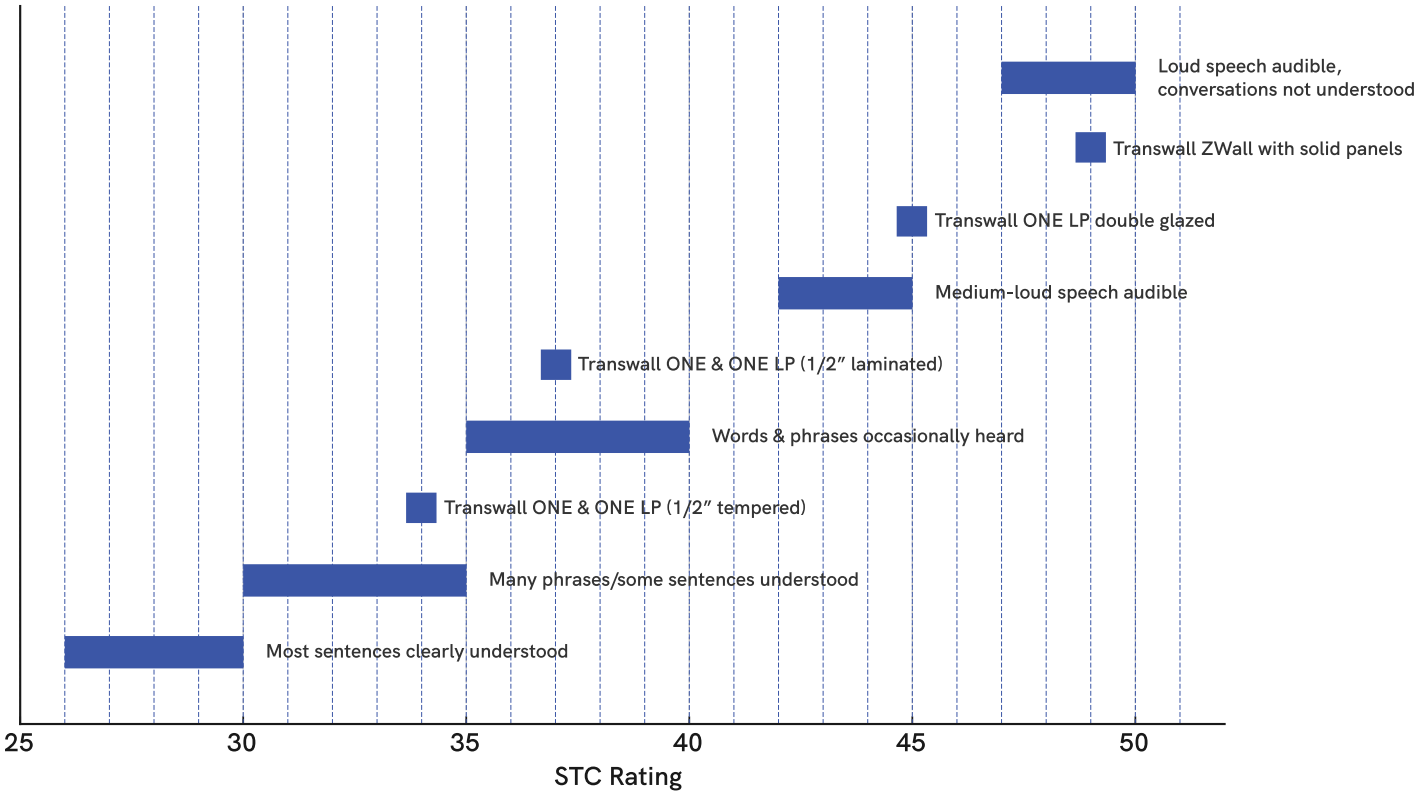

STC differences of <2 dB are barely perceptible to most observers

Designing for Best Results

Achieving your desired acoustic performance requires attention to every part of the space:

- Select the right wall system with an STC rating that aligns with your project goals.
- Ensure professional installation with proper sealing at the junctions between walls, floors, and ceilings.
- Consider other building components—such as ceiling tiles, ductwork, and doors—that may create flanking paths where sound can bypass the wall.

Even the highest-performing wall system will only be as good as its weakest link. Coordinating with architects, contractors, and building engineers early in the process ensures that the entire space works together to deliver the intended acoustic result.

A Note on Published Ratings

Be sure to compare system STC ratings, not just the glass STC. Some manufacturers quote only the glass rating, which can overstate actual performance by 2-4 points since sound leaks around edges. Transwall provides verified system-level lab tests so you know exactly how the wall will perform.



GLASS TYPES

The beauty of glass is at the core of Transwall’s ONE system. From crystal clear panels that allows natural light to flood through workspaces, to a virtually limitless array of decorative architectural glass options, the ONE system is designed to bring your unique vision to light.

Glass Options

From clarity to style, Transwall offers multiple specialty glass options to support your design vision. Low Iron glass ensures ultra-clear visibility with minimal green tint, while tinted glass softens light and adds subtle warmth. Architectural textured or acid-etched glass creates depth and privacy, and decorative films or digital printing can deliver patterns, branding, or one-of-a-kind designs.

Clarity vs. Privacy

Every space requires a balance of openness and privacy. High-clarity options like Low Iron glass are ideal for bright, collaborative areas, while laminated, etched, or switchable glass enhances privacy without sacrificing visual appeal.

Structural Considerations

Glass performance is not only about clarity but also about scale and application. Standard glass supports full-height installations up to 10’, with segmented designs extending to 12’. For projects with non-standard or high-load conditions, Transwall provides expert consultation to ensure performance and compliance.

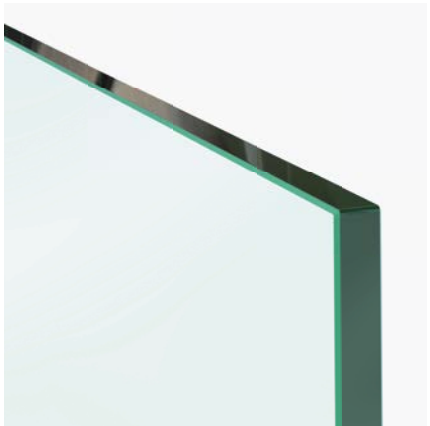

1/2” Monolithic Tempered Glass

The most widely used option across configurations, monolithic tempered glass is heat-treated for strength and safety while maintaining a clean, modern appearance. It provides a cost-effective solution that delivers both durability and simplicity for everyday applications.

- Standard option across most configurations
- Heat-treated for strength and safety
- Cost-effective and clean-lined



1/2” Laminated Glass (ONE LP only)

Laminated glass includes an acoustic interlayer that enhances privacy and sound control, making it ideal for spaces that demand quieter environments. Available in standard or acoustic formats, this option balances performance with visual clarity for improved functionality.

- Adds an acoustic interlayer for improved sound control
- Available in standard or acoustic laminated formats
- Enhances both privacy and performance



Switch Glass (Laminated, ONE LP only)

Switch glass offers instant flexibility by electronically shifting between clear and frosted states. Built directly into the glass for durability, it provides on-demand privacy without the need for shades or blinds—perfect for conference rooms and executive offices.

- Electrically switchable between clear and frosted states
- Offers instant visual privacy without mechanical shades
- Built into the glass (not surface-applied) for added durability and longevity

ANODIZED ALUMINUM

Low Profile Only

For projects that require the timeless look of aluminum, anodized finishes offer a natural metallic appearance with enhanced resistance to wear and corrosion. Available in Clear, Medium Bronze, and Black, anodized aluminum is an excellent choice for creating a clean, architectural aesthetic.



Medium Bronze

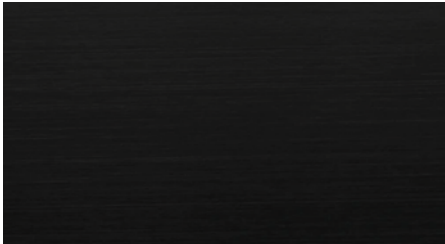

Black



Clear

POLISHED ALUMINUM

Low Profile Only

When your design calls for a high-impact, reflective look, our polished aluminum delivers. This sleek, mirror-like finish is ideal for high-end applications where a modern, sophisticated edge is essential.



Polished Aluminum

POWDER COAT FINISHES

Standard and Custom

Our powder coat finishes deliver exceptional durability with a consistent, flawless color that’s hard to achieve with anodizing. Designed with sustainability in mind, they produce low VOC emissions, minimize waste, and offer high impact with minimal environmental footprint.

STANDARD OPTIONS

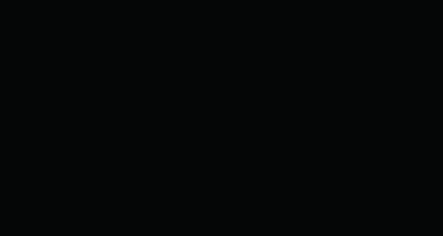

Matte Millennium Black (479)



Signal White (455)



Champagne Metallic (502)

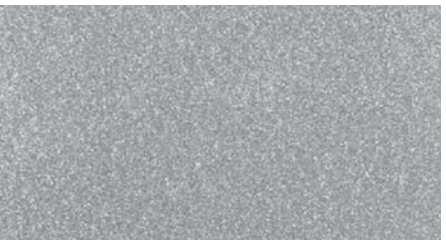

Silver Metallic (613)



Medium Bronze Metallic (519)

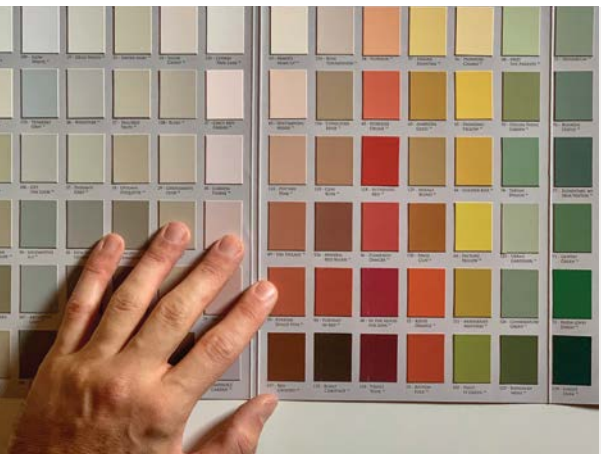

CUSTOM COLOR SPECIALISTS

With our paint department and finishing capabilities, you’re never limited to just standard choices—we can customize finishes to align with your exact design vision, ensuring every detail meets your project requirements.

TRANSWALL DOORS

The Transwall ONE system gives you the flexibility to choose the right door solution for your space—balancing aesthetics, accessibility, acoustic performance, and hardware compatibility. Whether you need the clean, minimal look of a sliding door or the timeless functionality of a pivot door, Transwall offers both options with precision engineering and customizable details.

DOOR FUNCTION OPTIONS

- **Sliding Doors:** Provide smooth-glide operation, optional integrated dampeners, and enhanced acoustic performance through seals and drop seals.
- **Pivot Doors:** Offer surface-mounted or concealed closer options, magnetic latching for secure closure, and full 4-sided acoustic sealing with drop seals and integral gasketing.

Beyond function, you can also select from eight different door leaf designs to match your aesthetic vision, as well as a range of hardware options to meet operational and security needs. Pulls are available in ladder styles and ADA-compliant options, while locking solutions range from simple non-locking to advanced electrified mortise sets and electromagnetic locks.

For projects that require enhanced performance, acoustic sealing options—including perimeter gasketing, drop seals, and mating receivers—further elevate comfort and privacy.



PIVOT DOORS

Pivot doors offer a timeless and versatile solution, combining elegance with functionality. Designed for smooth operation and dependable performance, Transwall pivot doors are available with either surface-mounted or concealed closers, as well as a variety of hardware and acoustic sealing options. They're ideal for spaces where durability, accessibility, and a refined architectural look are equally important.

SINGLE PIVOT APPLICATION

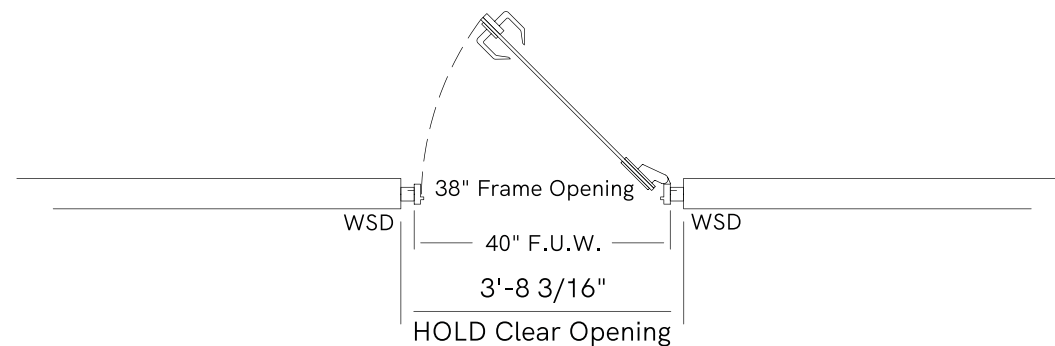

DOUBLE PIVOT APPLICATION

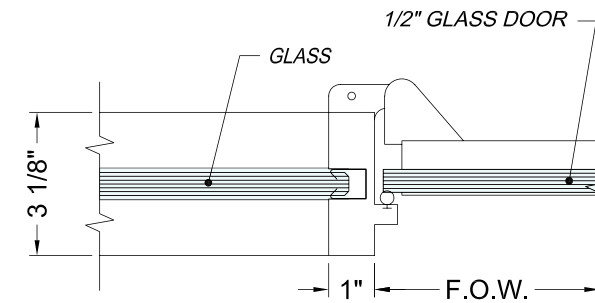
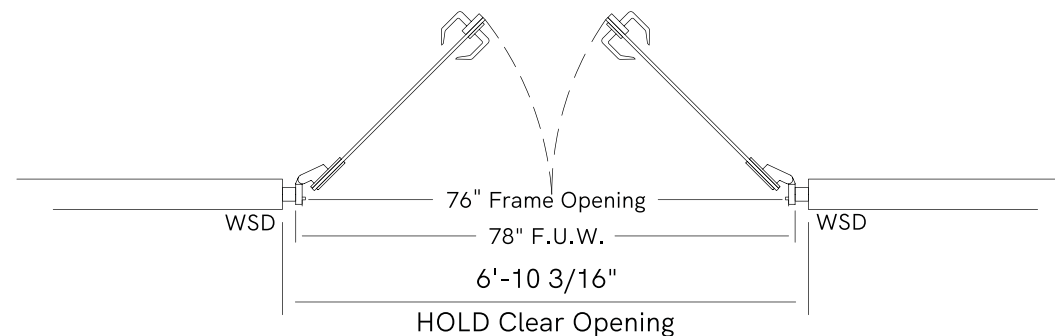

DOOR JAMB - PIVOT HINGE
HINGE SIDE - OFFSET PIVOT

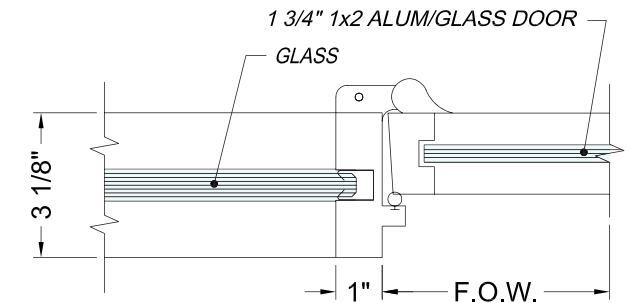

DOOR JAMB - PIVOT HINGE
HINGE SIDE - OFFSET PIVOT

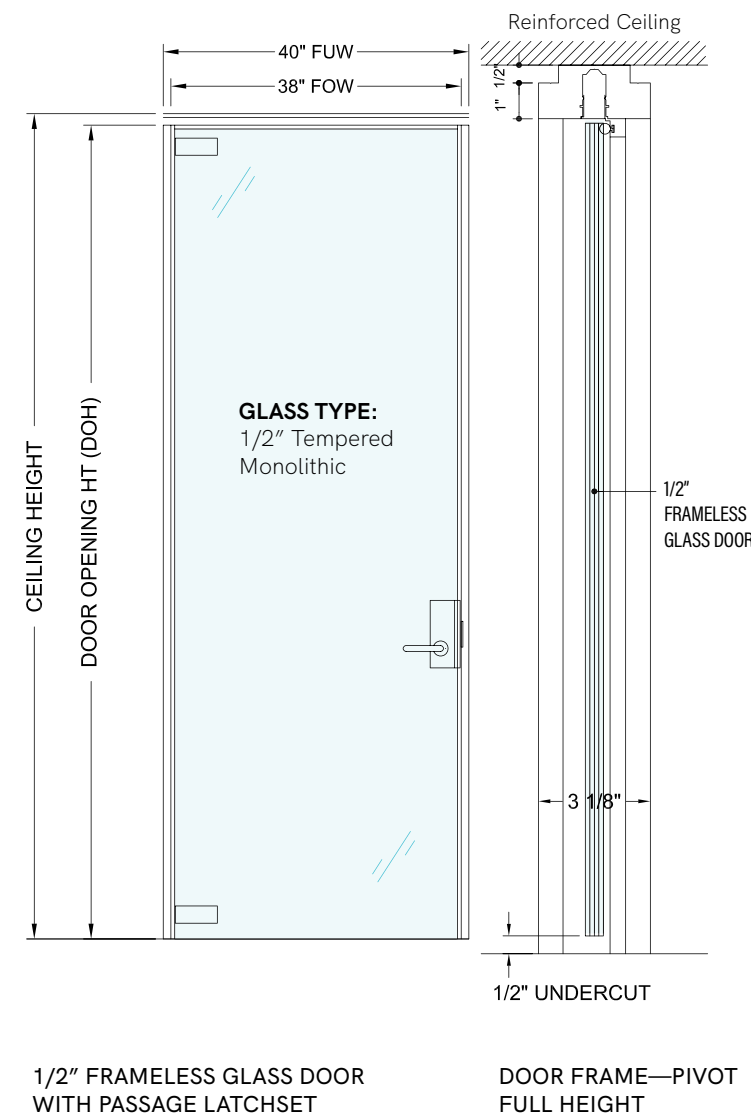

1/2" FRAMELESS GLASS DOOR
WITH PASSAGE LATCHSET

DOOR FRAME—PIVOT
FULL HEIGHT

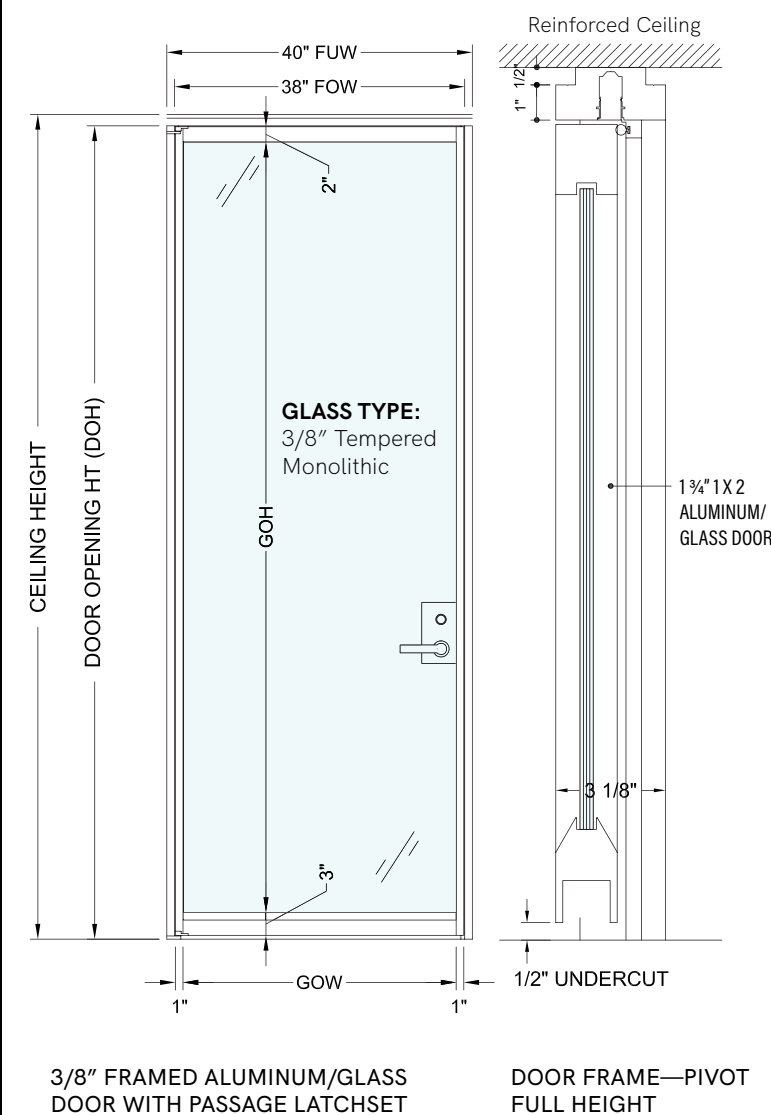

3/8" FRAMED ALUMINUM/GLASS
DOOR WITH PASSAGE LATCHSET

DOOR FRAME—PIVOT
FULL HEIGHT

SLIDING DOORS

Sliding doors deliver a sleek, modern aesthetic while maximizing usable floor space. Engineered for effortless movement, Transwall sliding doors feature smooth-glide operation with optional dampeners and enhanced acoustic seals for privacy and comfort. They are a perfect choice for environments that require flexibility, quiet operation, and a streamlined design.

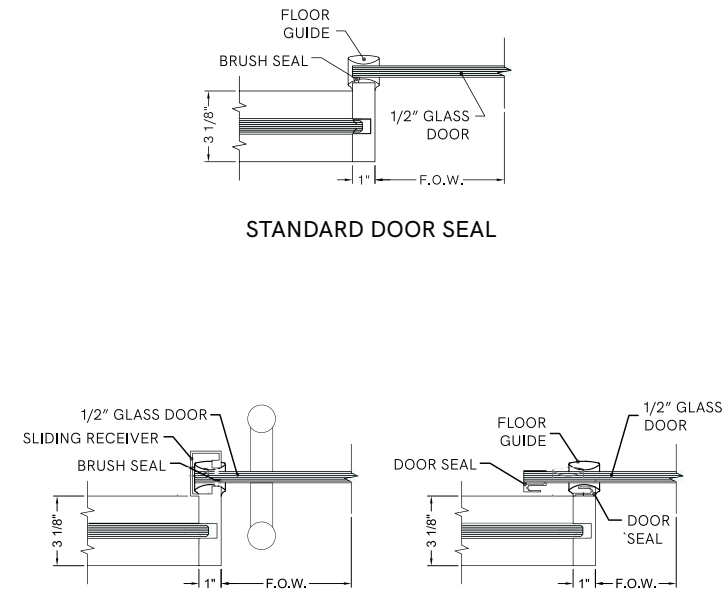
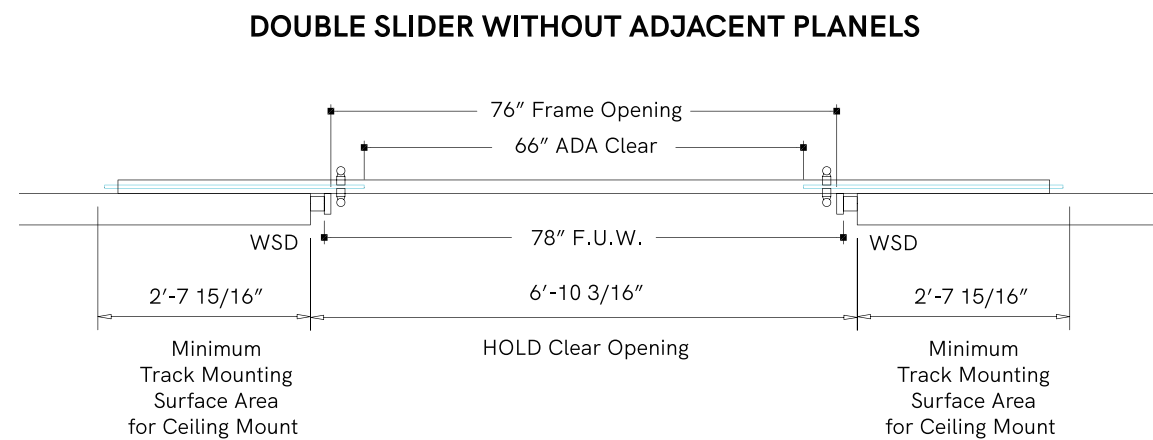
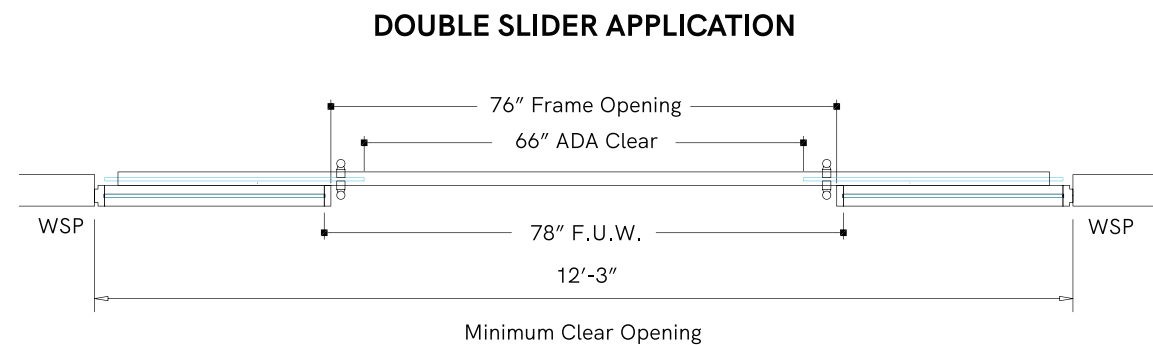

STANDARD DOOR SEAL

HIGH ACOUSTIC PERFORMANCE SEAL

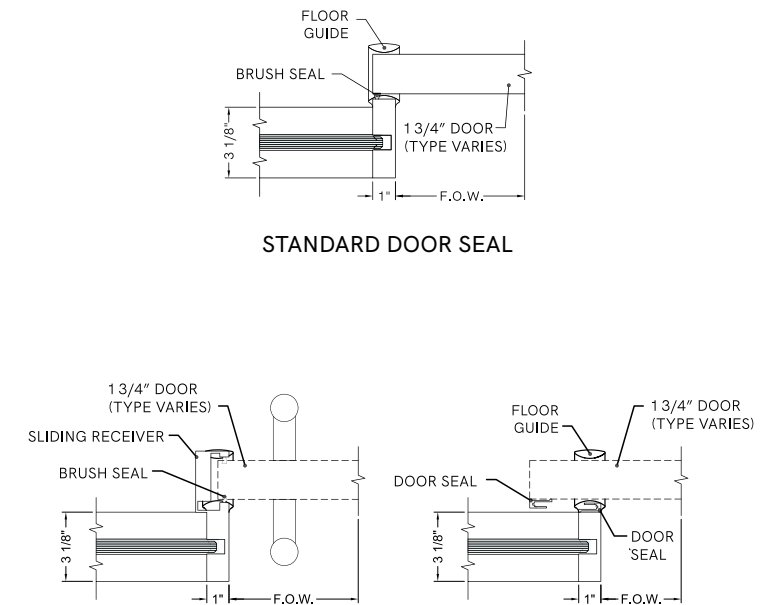

STANDARD DOOR SEAL

HIGH ACOUSTIC PERFORMANCE SEAL

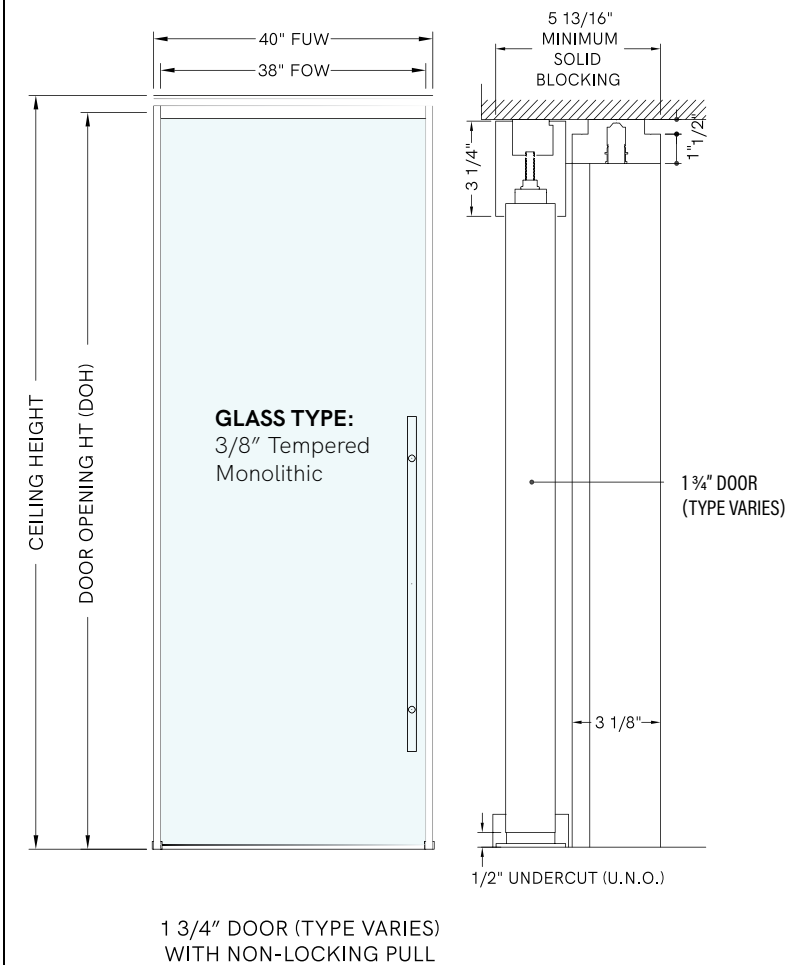
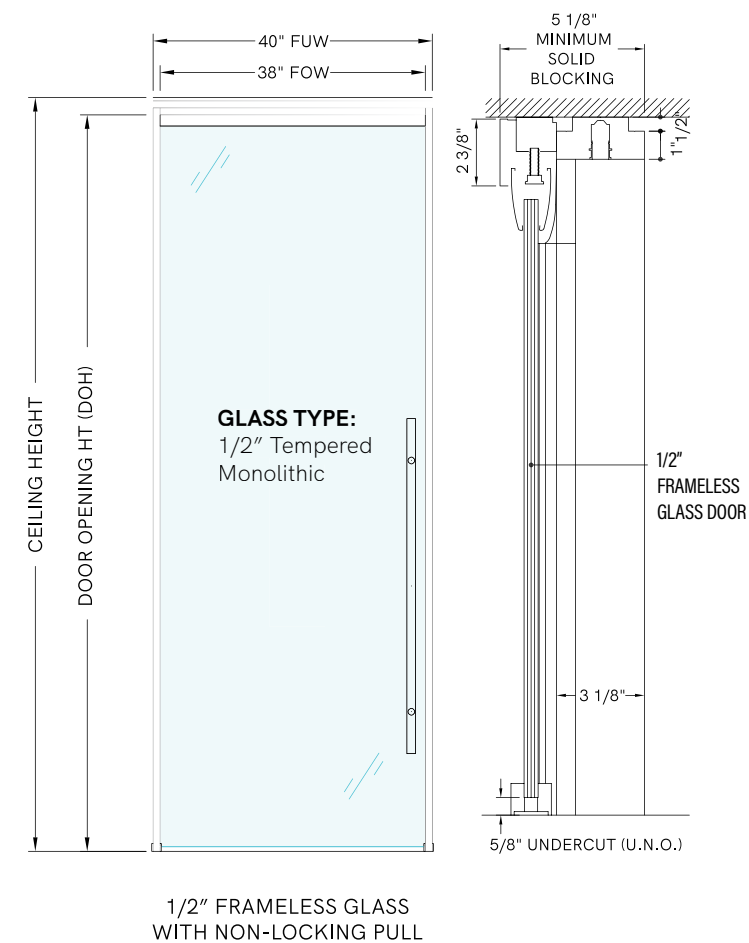



DOOR LEAVES

Transwall doors bring clean design and architectural presence to interior spaces. The result is smooth, balanced motion and a sleek, modern profile that integrates effortlessly with the ONE system. Available in a range of styles — including frameless glass, wood-framed, and double-glazed — these doors offer both aesthetic versatility and reliable performance across a wide range of environments.

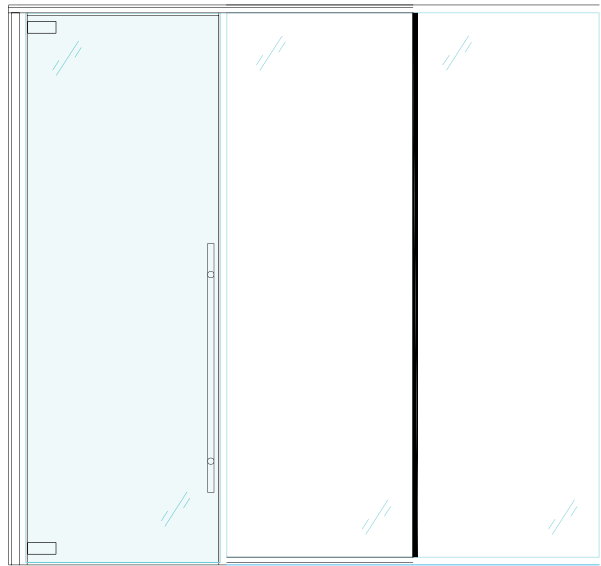

FRAMELESS GLASS
A sleek, all-glass design that offers unobstructed views and a clean, contemporary look.

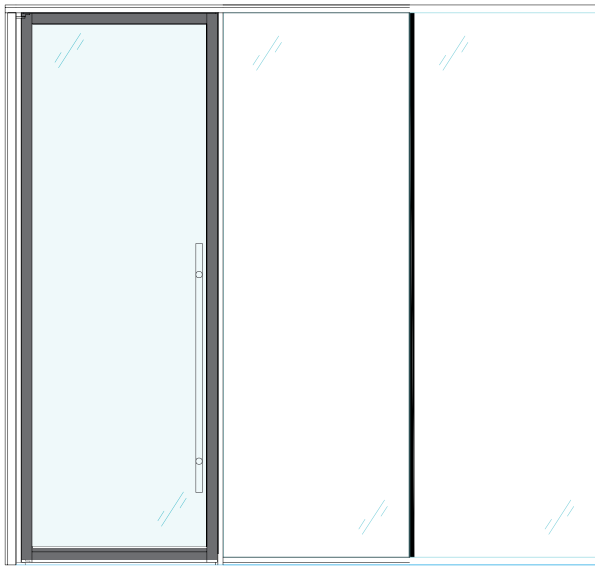

2X2
A fully framed glass door with balanced vertical and horizontal elements for a structured appearance.



FULL GLASS ALUMINUM
A clear glass panel framed in durable aluminum — combining transparency with strength.



DOUBLE-GLAZED
Incorporates two layers of glass for enhanced acoustic performance and privacy.

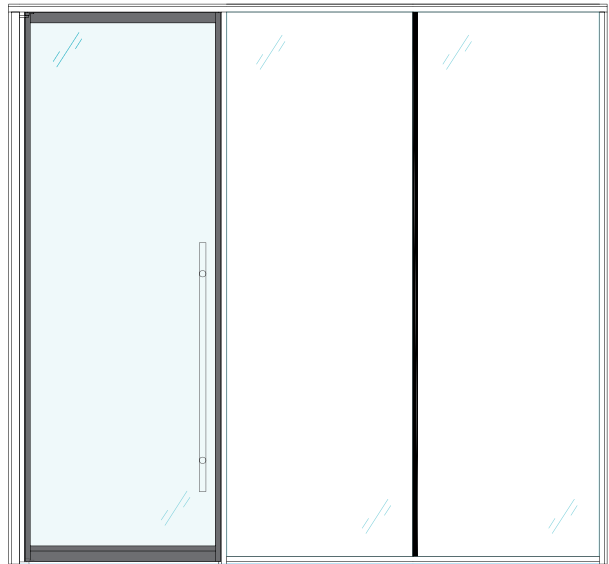

1X2
Features a single vertical and two horizontal framing elements, providing subtle definition while maintaining transparency.

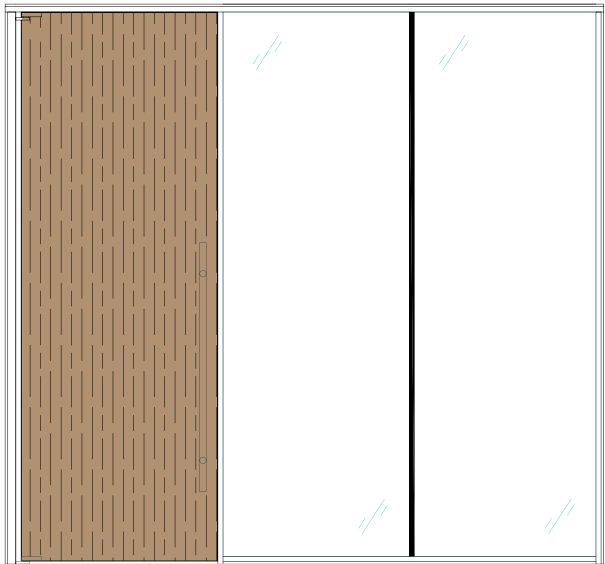

FLUSH WOOD
A wood door offering warmth and elegance.

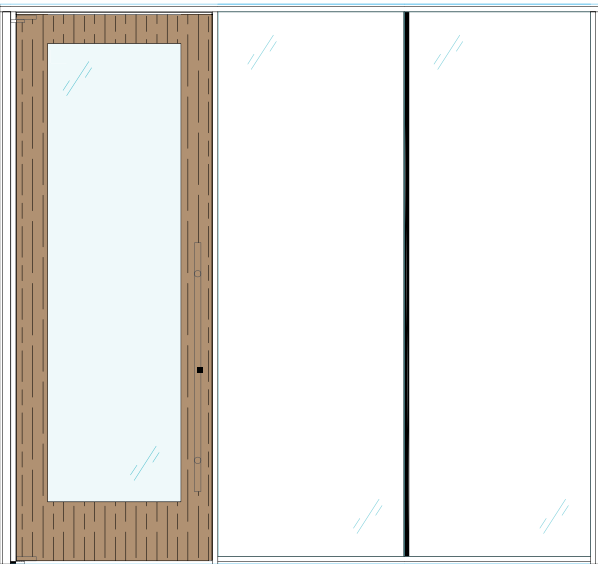

FULL GLASS WOOD
Merges the clarity of glass with the natural appeal of a wood frame, creating a harmonious blend of materials.



OFFSET-GLAZED
Features glass mounted to one side of the frame, offering a distinctive asymmetrical aesthetic.

CONNECTORS + CORNERS

The ONE system offers a wide range of connection options that adapt to virtually any layout. From clean corners to complex multi-directional hubs, these solutions ensure seamless transitions between panels, doors, drywall, and architectural elements while preserving both performance and aesthetics.

CORNER AND JUNCTION CONNECTIONS



90° Corners (2-way)

Crisp and precise corner connections create clean perpendicular layouts, maintaining a sharp architectural profile.



3-Way Junctions (T)

Perfect for connecting three glass walls at a single point, this junction supports streamlined layouts and expands flexibility for space planning.

WALL INTEGRATION POINTS

Panel Wall Start

Where glass meets existing drywall or building walls, this connection integrates seamlessly with the surrounding architecture. It ensures design continuity and a professional finish at wall terminations.

Door Frame Wall Start

This detail allows a framed door to connect smoothly to an adjacent wall, with precise spacing for a full 90° door swing and hardware clearance. The result is both functional and visually cohesive.

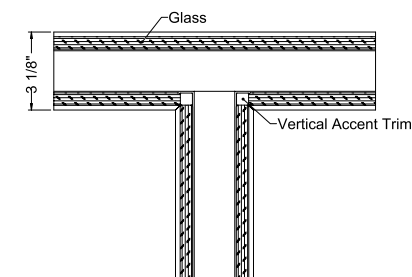

3-WAY 'T' CONDITION
5 GLASS PIECES

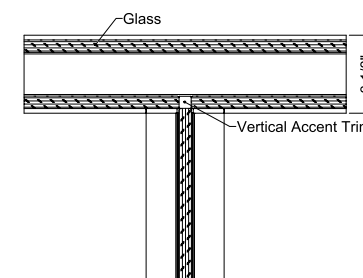

3-WAY 'T' CONDITION
4 GLASS PIECES

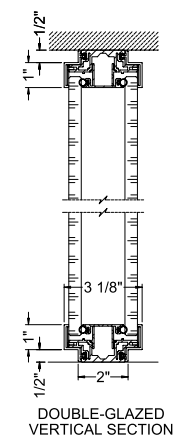

DOUBLE-GLAZED
VERTICAL SECTION

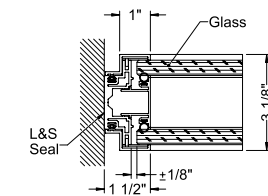

PANEL WALL START

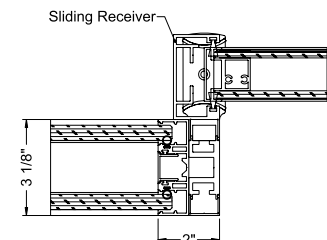

DOOR JAMB - SLIDING UNIT
DOUBLE-GLAZED CAPTURED GLASS
DOOR / LEADING END RECEIVER POST

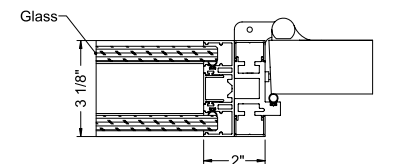

DOOR JAMB - PIVOT HINGE

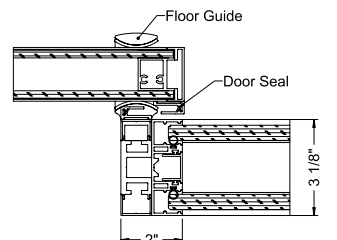

DOOR JAMB - SLIDING UNIT
DOUBLE-GLAZED CAPTURED GLASS
DOOR / TRAILING END INTERLOCKING
DOOR SEAL

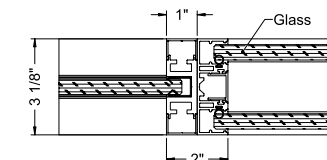

2" BYPASS CONDITION

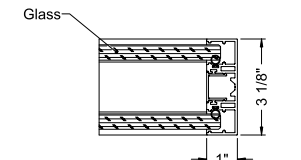

FINISHED END CONDITION

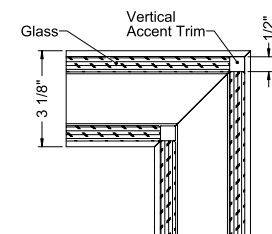

2 WAY 'L' CORNER



GLASS-TO-GLASS TRANSITIONS

For areas where glass walls meet directly, glass-to-glass transitions deliver a clean, modern look. Options include connections with bulb seals or accent trim finishes, allowing you to balance acoustics and design preferences. These transitions ensure visual continuity while maintaining performance across adjacent glass panels.

VERTICAL ACCENT TRIM

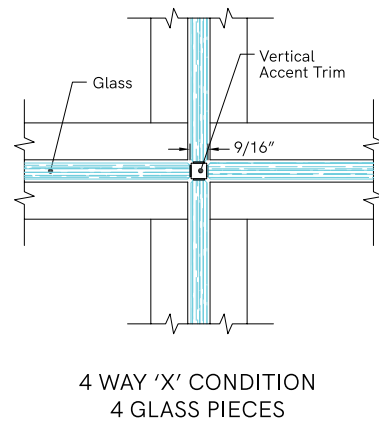
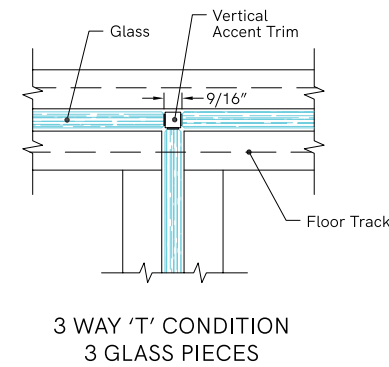
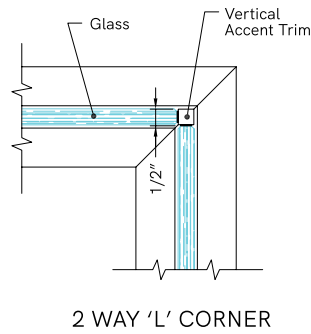

BULB SEAL

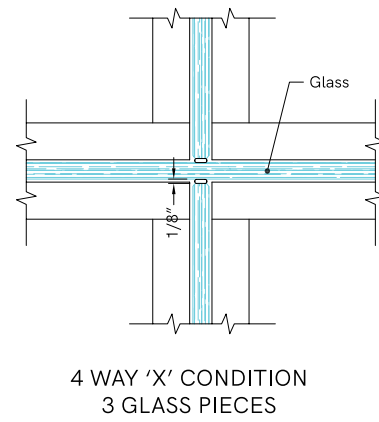
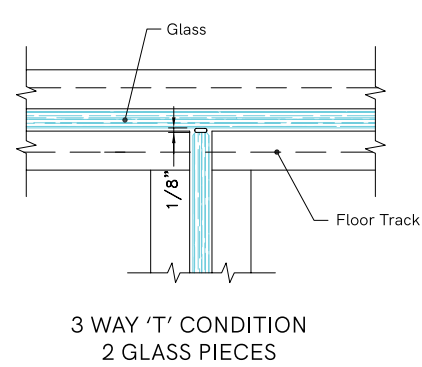
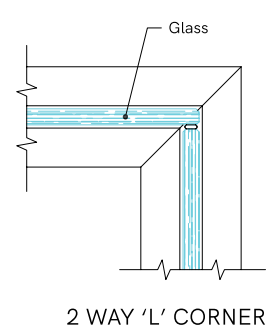

DEMISING WALL CONDITIONS

Drywall End Cap

Ideal where glass terminates directly into a traditional drywall or partition wall. This option provides a seamless transition that preserves both acoustic performance and finish integrity.

Bypass Panel Options

Bypass panels allow glass to “fly by” the demising wall, maintaining openness and visual flow. Available in 4”, 6”, and 8” standard widths (with custom options available), bypass panels create subtle separation without compromising flexibility. For minimal visual impact, a 2” bypass option is also available, though it offers reduced acoustic performance.

DEMISING WALL CONDITIONS OCCURRING AT GLASS PANELS

DEMISING WALL CONDITIONS OCCURRING AT DOOR FRAMES

HIGHEST

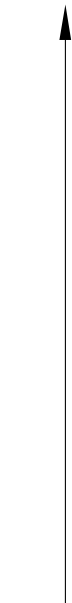

STC SCALE

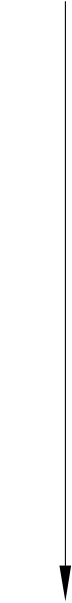

LOWEST

**OPTION #1
DRYWALL END CAP**

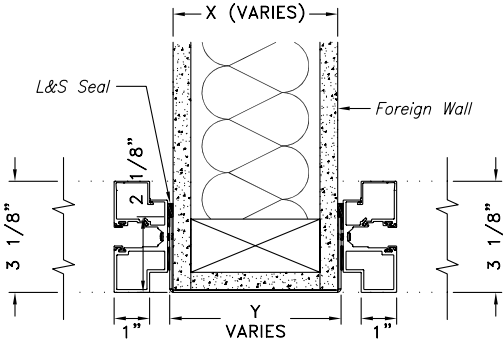

PANEL WALL STARTS

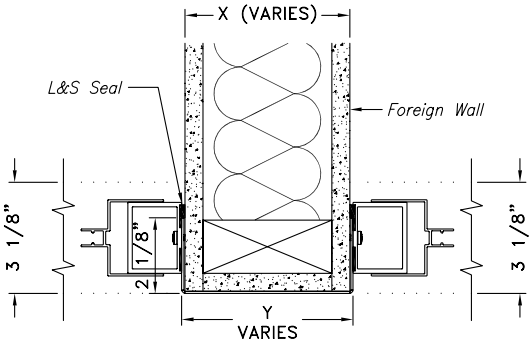

DOOR FRAME WALL STARTS

**OPTION #1
DRYWALL END CAP**

**OPTION #2
BYPASS PANELS**

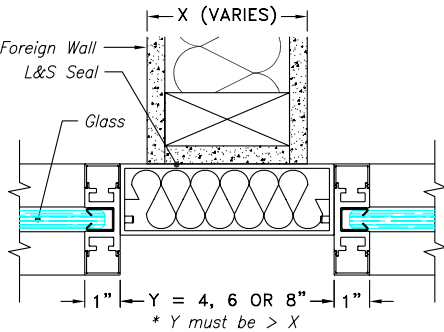

GLASS TO GLASS

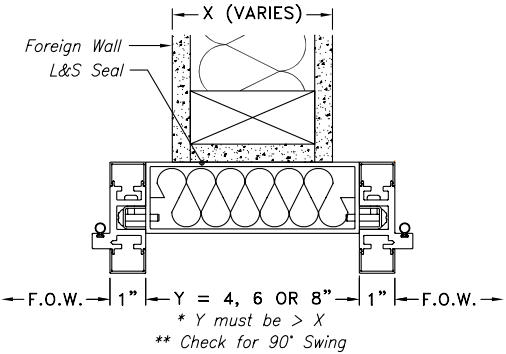

PIVOT DOOR TO PIVOT DOOR

**OPTION #2
BYPASS PANELS**

**OPTION #3
2" BYPASS**

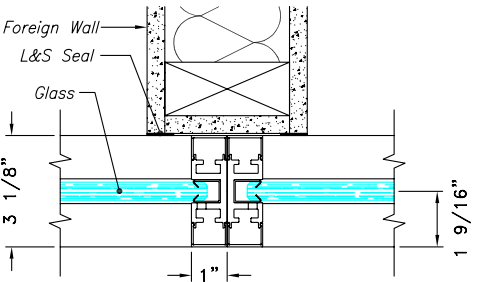

GLASS TO GLASS

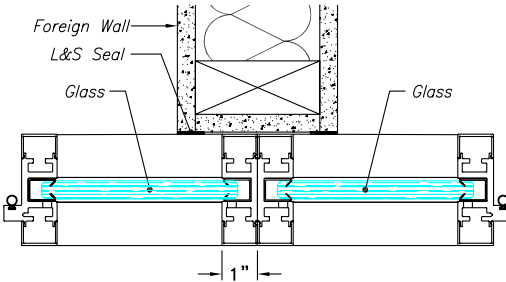

PIVOT DOOR TO PIVOT DOOR

**OPTION #3
2" BYPASS**



ACCESSORIES + ENHANCEMENTS

The ONE system can be tailored with functional and aesthetic upgrades that enhance performance, elevate design, and make your workspace more adaptable. From architectural accents to integrated technology, these options allow you to customize your system to meet both brand and operational needs.

Built for the Future

Every accessory and enhancement is designed not only to meet today's needs but also to anticipate tomorrow's. By combining architectural flexibility with integrated technology and adaptable finishes, the ONE system empowers spaces to evolve without compromise—future-proofing environments for long-term value and performance.

Decals & Branded Film

Glass surfaces become opportunities for identity, privacy, and storytelling with custom decals and branded films. Add logos, patterns, or wayfinding graphics to reinforce brand presence while creating functional privacy where needed. Easy to install and update, films can evolve alongside tenant or brand requirements, offering a cost-effective way to refresh your space without major renovations.



Integrated Wire Raceways

Seamlessly designed into the system, integrated wire raceways provide concealed channels for managing power, data, and control wiring. This hidden infrastructure supports switches, access control devices, and room scheduling technology while maintaining the system's clean, minimalist aesthetic. The result is a clutter-free environment that prioritizes both function and design integrity.

Tech Panels

Tech panels integrate electrical and technology components directly into the glass wall system, making them ideal for high-performance workspaces. With a 3.75" panel depth and widths ranging from 6" to 12", these panels accommodate standard electrical boxes and ensure that power, data, and other services are seamlessly built into the wall system.



Muntins & Mullions

Applied 1" aluminum muntins provide architectural depth and visual character to glass walls. Available in both recessed and flush profiles, they allow you to achieve a range of design expressions—from bold grid patterns to subtle references to traditional mullion detailing. This flexibility makes them ideal for projects looking to balance modern transparency with classic structure.



OFFSET GLAZED MUNTIN/MULLION



DOUBLE GLAZED MUNTIN/MULLION

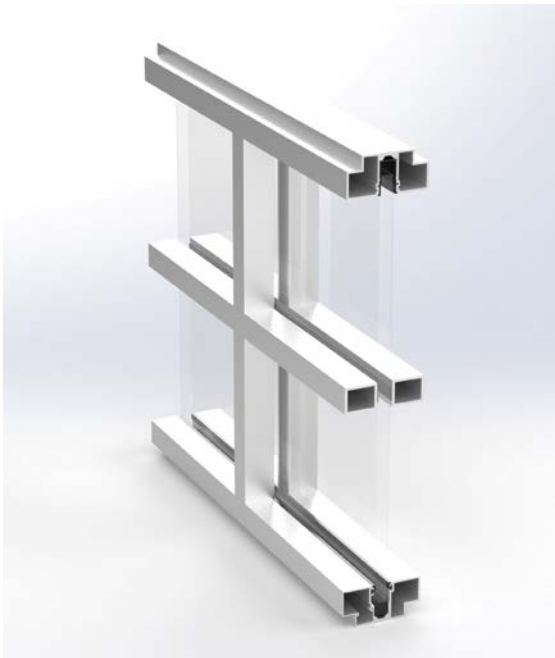

CENTER GLAZED MUNTIN/MULLION



HARDWARE

At Transwall, every detail matters—including the hardware. We partner exclusively with top-quality manufacturers to ensure our systems not only look refined but also perform with reliability and longevity. From precision-engineered hinges and pivots to sleek pulls, locks, and closers, each component is selected for durability, smooth operation, and seamless integration with our glass wall systems. The result is hardware that enhances functionality while complementing the clean, modern aesthetic of Transwall designs.

PULLS

Ø1 1/4" NON-LOCKING SHORT LADDER PULLS

Application Guidelines:

- For pivot doors without a closer specified, magnetic latch is used to keep door closed
- Sliding Track can be mounted inside or outside office
- Single + Double Full Height Sliding - All Door Types
- Single + Double Full Height Pivot - All Door Types
- Single + Double Transom Height Pivot - All Door Types

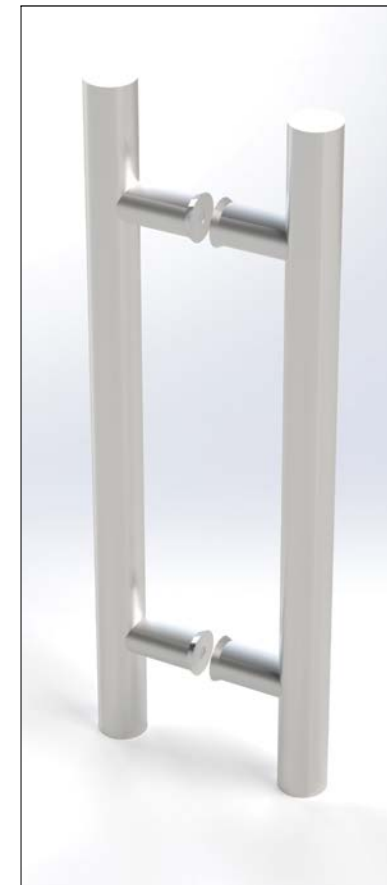

STANDARD SPECIFICATIONS

- 1 1/4" diameter tubing
- Lengths: 12", 18", 24", 30" or 36"
- Back-to-back mounting
- Standard Brushed stainless steel (630) finish
- Optional finish:
 - Matte black (MBLK/US19)
 - Other finishes available, additional lead times may apply
- Door Types
 - Frameless Glass Doors
 - 1 3/4" thick Doors

Ø1 3/8" NON-LOCKING & LOCKING PULLS

Application Guidelines:

- For pivot doors without a closer specified, magnetic latch is used to keep door closed
- Sliding Track can be mounted inside or outside office
- Single + Double Full Height Sliding – All Door Types
- Single + Double Full Height Pivot – All Door Types
- Single + Double Transom Height Pivot – All Door Types



1.375" DIAMETER LOCKING ADA BAR PULL



1.375" DIAMETER NON-LOCKING BAR PULL

STANDARD SPECIFICATIONS

- 1 3/8" diameter tubing
- Non-locking and Locking dead bolt down configurations
- Standard Lengths: 48" and 48" Staggered ADA
- Additional Lengths: 60", 72", & 84" (additional lead times apply)
- Back-to-back mounting
- Common door prep for ease of conversion between non-locking and locking
 - ADA thumbturn for locking pulls
- Dust proof keeper included with locking pulls
 - Required floor hole prep: 1" Ø x 2 1/2" Deep
- Standard Brushed stainless steel (630) finish
- Optional finish:
 - Matte black (MBLK/US19)
 - Other finishes available, additional lead times may apply
- Door Types:
 - Frameless Glass Doors
 - 1 3/4" thick Doors
- Keying Requirements
 - Small format (SFIC) construction cores supplied by Transwall



TRANSWALL CYLINDRICAL LEVERSETS | FRAMELESS GLASS DOORS

Application Guidelines: For use on single pivot doors (not available on double doors)



LEVER LATCHSET

- Accentra 4600LN Series
- ANSI/BHMA A156.2 Grade 2 certified for long life and reliability
- Field reversible handing for easy installation
- 2 3/4" backset
- 4601LN Passage function (ANSI Code F75)
- Augusta (AU) lever handle meets ADA requirements
- Standard Brushed chrome plated (626) finish
- Optional finishes:
 - Black suede powder coat (BSP)
 - Dark oxidized satin bronze, equivalent (613E)



LEVER LOCKSET

- Accentra 4600LN Series
- ANSI/BHMA A156.2 Grade 2 certified for long life and reliability
- Field reversible handing for easy installation
- 2 3/4" backset
- 4604LN Entry function (ANSI Code F82A)
- Augusta (AU) lever handle meets ADA requirements
- Standard Brushed chrome plated (626) finish
- Optional finishes:
 - Black suede powder coat (BSP)
 - Dark oxidized satin bronze, equivalent (613E)

Keying Requirements

- Compatible with Small format interchangeable (SFIC) cores only
- SFIC Construction cores supplied by Transwall

TRANSWALL CYLINDRICAL LEVERSETS | 1 3/4" THICK DOORS

Application Guidelines:

- For use on single pivot doors (not available on double doors)
- Applicable door types: 5" wide stile aluminum full glass | Wood (flush and full glass) | 1x2 aluminum full glass
2x2 aluminum full glass | Double-glazed aluminum full glass | Offset-glazed aluminum full glass



LEVER LATCHSET

- Accentra 4600LN Series
- ANSI/BHMA A156.2 Grade 2 certified for long life and reliability
- Field reversible handing for easy installation
- 2 3/4" backset
- 4601LN Passage function (ANSI Code F75)
- Augusta (AU) lever handle meets ADA requirements
- Standard Brushed chrome plated (626) finish
- Optional finishes:
 - Black suede powder coat (BSP)
 - Dark oxidized satin bronze, equivalent (613E)



LEVER LOCKSET

- Accentra 4600LN Series
- ANSI/BHMA A156.2 Grade 2 certified for long life and reliability
- Field reversible handing for easy installation
- 2 3/4" backset
- 4604LN Entry function (ANSI Code F82A)
- Augusta (AU) lever handle meets ADA requirements
- Standard Brushed chrome plated (626) finish
- Optional finishes:
 - Black suede powder coat (BSP)
 - Dark oxidized satin bronze, equivalent (613E)

Keying Requirements

- Compatible with Small format interchangeable (SFIC) cores only
- SFIC Construction cores supplied by Transwall

CYLINDRICAL PASSAGE LATCHSETS



BRUSHED CHROME PLATED
(626) FINISH

- Accentra 4601LN Passage function (ANSI Code F75)
 - For doors that do not require locking
 - Either lever operates latchbolt at all times
- Augusta (AU) lever handle meets ADA requirements

ALSO AVAILABLE IN:



Black Suede Powder Coat



Dark Oxidized Satin Bronze

CYLINDRICAL ENTRY LOCKSETS



BRUSHED CHROME PLATED
(626) FINISH

- Accentra 4604LN Entry function (ANSI Code F82A)
 - Deadlocking latchbolt
 - Either lever operates latchbolt except when outside lever is locked from inside
 - Pushing button in on inside lever locks outside lever.
 - Automatically releases when inside lever is turned or key is rotated in locked outside lever.
 - Latchbolt is operated by key in outside lever or by rotating inside lever
 - Inside lever always active
- Augusta (AU) lever handle meets ADA requirements

ALSO AVAILABLE IN:



Black Suede Powder Coat

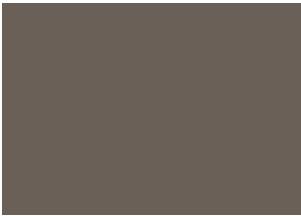

Dark Oxidized Satin Bronze



HINGES

PIVOT HINGES



NEO OFFSET PIVOT HINGE SET | 1 3/4" THICK DOORS

- Top + bottom pivot hinges
- Excludes 5" Aluminum Stile/Rail & Frameless Glass Doors
- Exact design will vary per door type
- Cannot accommodate floor closers
- Available in Transwall powder coat finishes only



NEO OFFSET PIVOT HINGE SET | 1/2" FRAMELESS GLASS DOORS

- Top + bottom pivot hinges
- Excludes 1 3/4" Thick Doors
- Cannot accommodate floor closers
- Available in Transwall powder coat finishes only



DOOR ACCESSORIES



FLOOR MOUNTED DOOR STOPS

- For use on either frameless glass or 1 3/4" thick doors
- Rockwood RM850
- Modern style
- Diameter: 1 1/4"
- Height: 1 1/2"
- Grey bumper
- Brushed chrome (626) finish
- Other Rockwood finishes available upon request
- Transwall powder coat finishes available upon request

ALSO AVAILABLE IN:

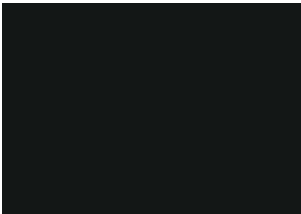

Black Suede Powder Coat

CLOSERS + LOCKS

CLOSERS



OVERHEAD SURFACE MOUNTED CLOSER



OVERHEAD CONCEALED CLOSER



FLOOR MOUNTED CLOSER

ELECTROMAGNETIC LOCK

- For use on either frameless glass or 1 3/4" thick pivot doors
- Mounted on push side of door
- Schlage M490P-ATS/LED (Single Doors)
- Schlage M492P-ATS/LED (Double Doors)
- Magnetic bond sensor
- Door position switch
- Adjustable relock time delay
- Anti-tamper switch
- Brushed aluminum (628) finish only (no other options)
- Decorative cover in Transwall powder coat finish available

DOOR SEALS

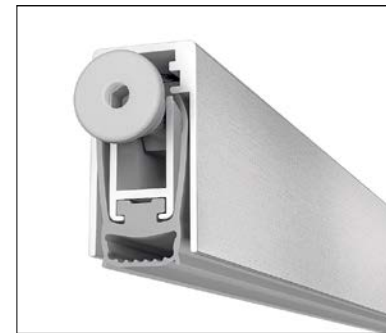

CE1528DR6



CE1213SML

AUTOMATIC DOOR SEAL

- Provide a secure sound seal and prevent unwanted distractions from adjacent spaces
- Provides a continuous seal along the entire length of the door
- Automatically retracts when the door is opened to prevent dragging or wear on flooring surfaces
- Sealing options available for all Transwall doors
- Noise reduction up to 52dB



PERFORMANCE + COMPLIANCE

The Transwall ONE system is engineered to meet demanding performance standards while maintaining design integrity, flexibility, and accessibility. Every product is designed for real-world conditions and is backed by third-party certifications for indoor air quality, sustainability, and environmental responsibility.

Environmental & Sustainability Standards

Transwall is committed to responsible material sourcing and environmentally sound manufacturing practices:

- FSC® Certification (License Code FSC®-C103773) ensures wood components are sourced responsibly.
- Products contribute to LEED v4 and v4.1 credits, including low-emitting materials, daylight and views, and waste reduction strategies.
- Powder coating processes are low-VOC, minimizing environmental impact while delivering durable finishes.
- Glass and aluminum components are recyclable, reducing lifecycle footprint and supporting circular economy practices.

ADA Compliance

Transwall door frames and hardware options can be specified to meet ADA guidelines. Configurations accommodate compliant clear openings, handle types, and mounting heights to support accessibility for all users. Optional 10" bottom rails for glass doors further enhance compliance, ensuring both style and inclusivity in design.

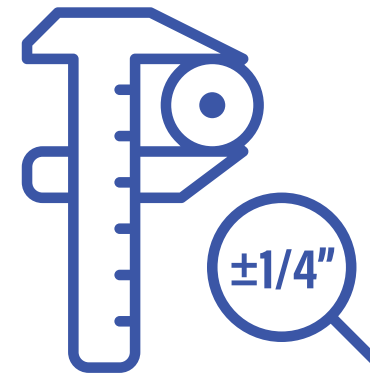

Installation Tolerances

Understanding that no construction site is ever perfectly uniform, the ONE system is engineered with flexibility in mind. Systems allow for $\pm 1/4$ " tolerances both vertically and horizontally, accommodating common floor and ceiling variations. This built-in adaptability makes installation faster, more reliable, and less dependent on field adjustments.

Ceiling & Floor Integration

Transwall partitions integrate seamlessly with a wide range of ceiling and flooring systems. Typical connection diagrams are available for project teams, ensuring smooth coordination during design and installation. This flexibility helps preserve acoustic integrity, maintain design intent, and simplify construction sequencing.

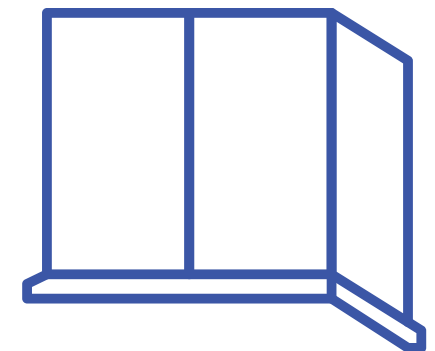

Indoor Air Quality

The Transwall ONE and LP systems are certified SCS Indoor Advantage™ Gold for indoor air quality. This certification verifies compliance with ANSI/BIFMA and CDPH standards, confirming that Transwall products meet the strictest requirements for low chemical emissions. These certifications apply to office, educational, and healthcare environments, supporting healthier indoor spaces.

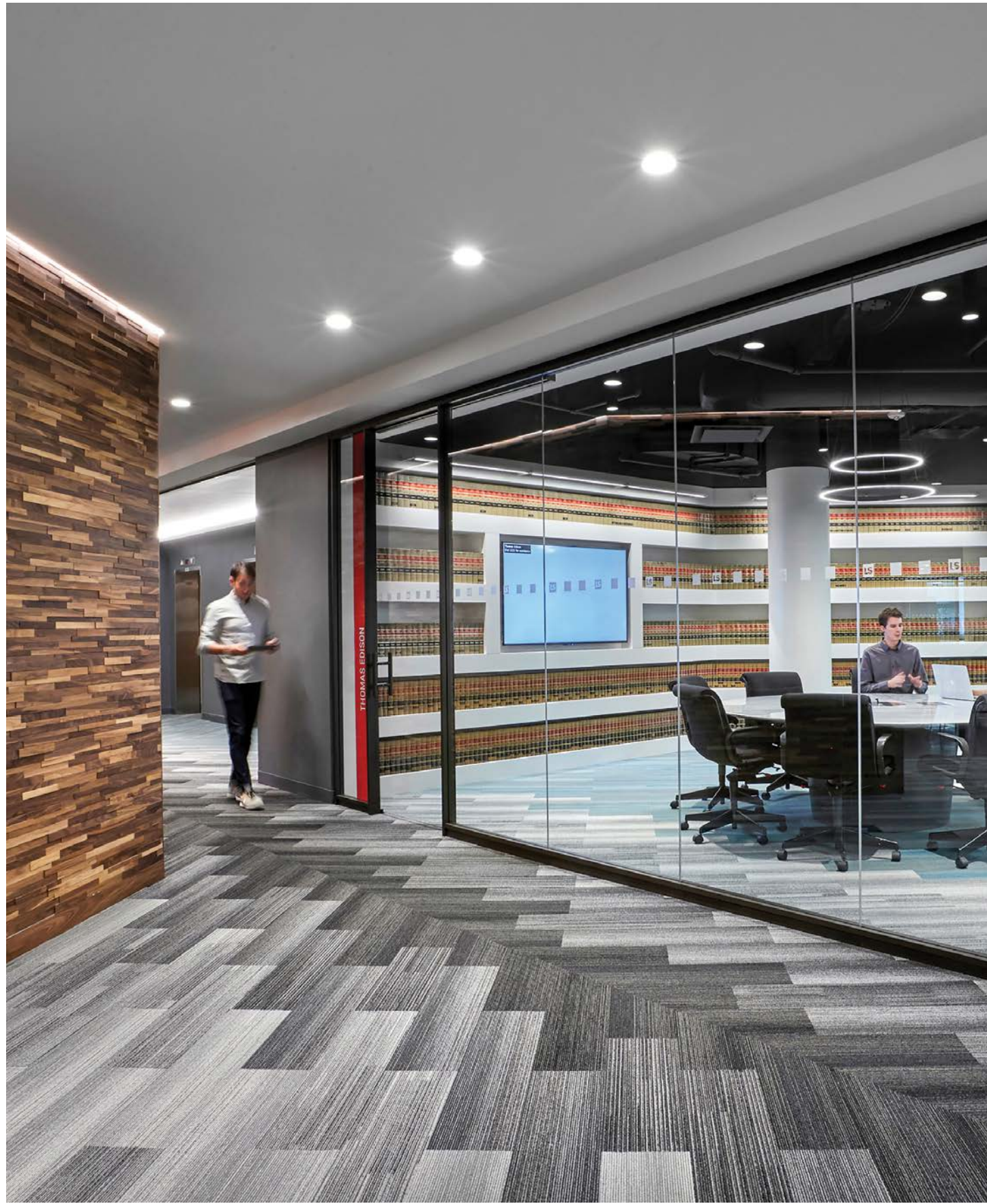

ONE: Product Scope

GENERAL NOTES

- Adjustability: ± 1/2” Tolerance (see supplemental sheet)
- Finishes: Powder Coat
- Floor Attachment: Physical anchoring required
- Ceiling Attachment: Ceiling grid or Soffit attachment

PANEL GLASS

- Widths up to 42” (wider may be available with ceiling heights less than 10’-0”)
- Heights up to 10’-0”
- Types
 - 1/2” Clear Tempered
 - 1/2” Clear Tempered Low Iron

CONNECTOR CONDITIONS

- 8”w Aluminum Bypass Panel (default), 4”w & 6”w (available)
- 2” Bypass Back-to-Back Verticals
- Finished End
- Wall Start at Door Frame
- Wall Start at Panel

TRIM

- 2-Way with Bulb Seal (Lap Joint)
- 2-Way 90° Corner Vertical Accent
- 3-Way with Bulb Seal (2 pieces of glass)
- 3-Way Vertical Accent (requires 3 pieces of glass)
- 4-Way with Bulb Seals (3 pieces of glass)
- 4-Way Vertical Accent (requires 4 pieces of glass)
- Applied horizontal muntins
 - 1”h x 1 1/4”d
 - 1”h x 1/4”d
- Applied vertical mullions
 - 1”h x 1 1/4”d
 - 1”h x 1/4”d

SLIDING DOOR FRAMES | DOORS | HARDWARE

- Single Full Height Sliding Frame
- Double Full Height Sliding Frame
- Frameless Glass Door
 - 1/2” Clear Tempered
 - 1/2” Clear Tempered Low Iron
- Non-Locking Ladder Pull
- Dead Bolt Down Locking Ladder Pull, including ADA option
- Dead Bolt Up Locking Ladder Pull
- Optional Open/Close Dampeners

PIVOT DOOR FRAMES | DOORS | HARDWARE

- Single Full Height Pivot Frame
- Double Full Height Pivot Frame
- Single Transom Height Pivot Frame
- Double Transom Height Pivot Frame
- Frameless Glass Pivot Door (up to 9’-0”)
 - 1/2” Clear Tempered
 - 1/2” Clear Tempered Low Iron
- 1 3/4” Thick Door (up to 10’-0”)
 - 1x2 Thin Framed Aluminum Glass Door
 - Flush Wood Door
 - Full Glass Wood Door
 - 5” Stile/Rail Aluminum Glass Door
- Mortise Leverset
- Non-Locking + Locking Ladder Pulls
- Modern Floor Door Stop
- Floor Mounted Closer
- Overhead Concealed Closer (some 1 3/4” thick doors)
- Electromagnetic Lock
- Surface Mounted Door Bottom
- Semi-Mortised Door Bottom (Wood door only)

ONE LOW PROFILE: Product Scope

GENERAL NOTES

- Adjustability (see supplemental sheets):
 - Traditional Trim: ± 1/4" Tolerance
 - Front Load Trim: ± 1/2" Tolerance
- Finishes: Powder Coat or Anodized
- Floor Attachment: Physical anchoring required
- Ceiling Attachment: Soffit ONLY (NO ceiling grid attachment)

PANEL GLASS

- Widths up to 42" (wider may be available with ceiling heights less than 10'-0")
- 1/2" Glass (ceiling heights up to 10'-0")
- 3/8" Glass (ceiling heights up to 8'-0")

CONNECTOR CONDITIONS

- 8"w Aluminum Bypass Panel (default), 4"w & 6"w (available)
- 2" Bypass Back-to-Back Verticals
- Finished End
- Wall Start at Door Frame
- Wall Start at Panel

TRIM

- 2-Way with Bulb Seal (Lap Joint)
- 2-Way 90° Corner Vertical Accent
- 3-Way with Bulb Seal (2 pieces of glass)
- 3-Way Vertical Accent (requires 3 pieces of glass)
- 4-Way with Bulb Seals (3 pieces of glass)
- 4-Way Vertical Accent (requires 4 pieces of glass)
- Applied horizontal muntins
 - 1"h x 1 1/4"d
 - 1"h x 1/4"d
- Applied vertical mullions
 - 1"h x 1 1/4"d
 - 1"h x 1/4"d

SLIDING DOOR FRAMES | DOORS | HARDWARE

- Single Full Height Sliding Frame
- Double Full Height Sliding Frame
- 1/2" Frameless Glass Door
- 1 3/4" Thick Doors
 - 1x2 Thin Framed Aluminum Glass Door
 - 2x2 Narrow Framed Aluminum Glass Door
 - Double-Glazed Door
 - Offset-Glazed Door
 - Flush Wood Door
 - Full Glass Wood Door
 - 5" Stile/Rail Aluminum Glass Door
- Non-Locking Ladder Pull
- Dead Bolt Down Locking Ladder Pull, including ADA option
- Dead Bolt Up Locking Ladder Pull
- Optional Open/Close Dampeners

PIVOT DOOR FRAMES | DOORS | HARDWARE

- Single Full Height Pivot Frame
- Double Full Height Pivot Frame
- Single Transom Height Pivot Frame
- Double Transom Height Pivot Frame
- 1/2" Frameless Glass Door (full height up to 9'-0")
- 1 3/4" Thick Doors (full height up to 10'-0")
 - 1x2 Thin Framed Aluminum Glass Door
 - 2x2 Narrow Framed Aluminum Glass Door
 - Double-Glazed Door
 - Offset-Glazed Door
 - Flush Wood Door
 - Full Glass Wood Door
 - 5" Stile/Rail Aluminum Glass Door
- Mortise Leverset
- Non-Locking Pull

- Dead Bolt Down Locking Ladder Pull, including ADA option
- Dead Bolt Up Locking Ladder Pull
- Modern Floor Door Stop
- Overhead Surface Mounted & Concealed Closers
- Electromagnetic Lock
- Surface Mounted Door Bottom
- Semi-Mortised Door Bottom (Wood doors only)
- Mortised Door Bottom (door type availability varies)

GLASS

PANELS

- Edges will be ground
- 1/2” Tempered Glass (Monolithic)
- 1/2” Annealed Laminated Glass
- 1/2” Acid-Etched Glass (Full Height Etching Required)
- 3/8” Tempered Glass (Monolithic)
- 3/8” Annealed Laminated Glass
- 3/8” Acid-Etched Glass (Full Height Etching Required)

DOORS | SLIDING

- 1/2” Frameless Glass Doors
 - Edges will be polished
 - 1/2” Tempered Glass (Monolithic)
 - 1/2” Tempered Laminated Glass
- 1x2 Thin Framed Aluminum Glass Doors
 - 3/8” Tempered Glass (Monolithic)
 - 3/8” Tempered Laminated Glass
- 2x2 Narrow Framed Aluminum Glass Doors
 - 3/8” Tempered Glass (Monolithic)
 - 3/8” Tempered Laminated Glass
- Double-Glazed Doors
 - 1/4” Tempered Glass (Monolithic)
- Offset-Glazed Doors
 - 3/8” Tempered Glass (Monolithic)
 - 3/8” Tempered Laminated Glass
- Full Glass Wood Doors
 - 1/4” Tempered Glass (Monolithic)
 - 1/4” Tempered Laminated Glass
 - 3/8” Tempered Glass (Monolithic)
 - 3/8” Tempered Laminated Glass
 - 1/2” Tempered Glass (Monolithic)
 - 1/2” Tempered Laminated Glass
- 5” Stile/Rail Aluminum Glass Doors
 - 1/4” Tempered Glass (Monolithic)
 - 1/4” Tempered Laminated Glass

- 3/8” Tempered Glass (Monolithic)
- 3/8” Tempered Laminated Glass
- 1/2” Tempered Glass (Monolithic)
- 1/2” Tempered Laminated Glass

DOORS | PIVOT

- 1/2” Frameless Glass Doors
 - Edges will be polished
 - 1/2” Tempered Glass (Monolithic)
 - Laminated glass is NOT available with frameless glass pivot doors
- 1x2 Thin Framed Aluminum Glass Doors
 - 3/8” Tempered Glass (Monolithic)
 - 3/8” Tempered Laminated Glass
- 2x2 Thin Framed Aluminum Glass Doors
 - 3/8” Tempered Glass (Monolithic)
 - 3/8” Tempered Laminated Glass
- Double-Glazed Doors
 - 1/4” Tempered Glass (Monolithic)
- Offset-Glazed Doors
 - 3/8” Tempered Glass (Monolithic)
 - 3/8” Tempered Laminated Glass
- Full Glass Wood Doors
 - 1/4” Tempered Glass (Monolithic)
 - 1/4” Tempered Laminated Glass
 - 3/8” Tempered Glass (Monolithic)
 - 3/8” Tempered Laminated Glass
 - 1/2” Tempered Glass (Monolithic)
 - 1/2” Tempered Laminated Glass
- 5” Stile/Rail Aluminum Glass Doors
 - 1/4” Tempered Glass (Monolithic)
 - 1/4” Tempered Laminated Glass
 - 3/8” Tempered Glass (Monolithic)
 - 3/8” Tempered Laminated Glass
 - 1/2” Tempered Glass (Monolithic)
 - 1/2” Tempered Laminated Glass

PROJECT PLANNING

Bringing the ONE system into your project is simple and supported every step of the way. From initial design intent to final installation, our team ensures that specifications align seamlessly with your vision and project requirements.

How to Specify the ONE System

- Choose your glazing configuration: center, offset, or double.
- Select your system profile: ONE or ONE LP.
- Define your glass type, finish options, and door configuration.
- Rely on our team to guide you through every decision and provide support throughout the process.

Need Samples or Drawings?

We provide material samples upon request to help you evaluate finishes and options in person. Technical resources, including Revit files and CAD blocks, are readily available for download, and QR codes offer instant access to technical specifications, details, and inspiration galleries.

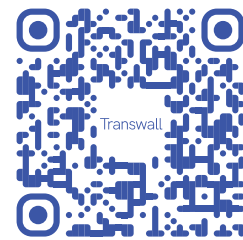

Connect With a Rep

Your local Transwall representative is available to discuss project requirements, coordinate showroom visits, or provide guidance on custom solutions. For national and complex project inquiries, visit transwall.com/contact to connect directly with our team, or call (800) 441-9255 to start the conversation!

[TRANSWALL.COM](https://transwall.com)

Transwall

WE LOOK FORWARD TO BRINGING YOUR VISION TO LIFE.

The ONE System brings every element together in perfect balance. With Transwall, thoughtful design and seamless execution go hand in hand, every step of the way.

1220 WILSON DR, WEST CHESTER, PA 19380 | (800) 441-9255 | [TRANSWALL.COM](https://www.transwall.com)