



Product Overview Silence

Transwall 800.441.9255









SIL
EN
CE



Transwall

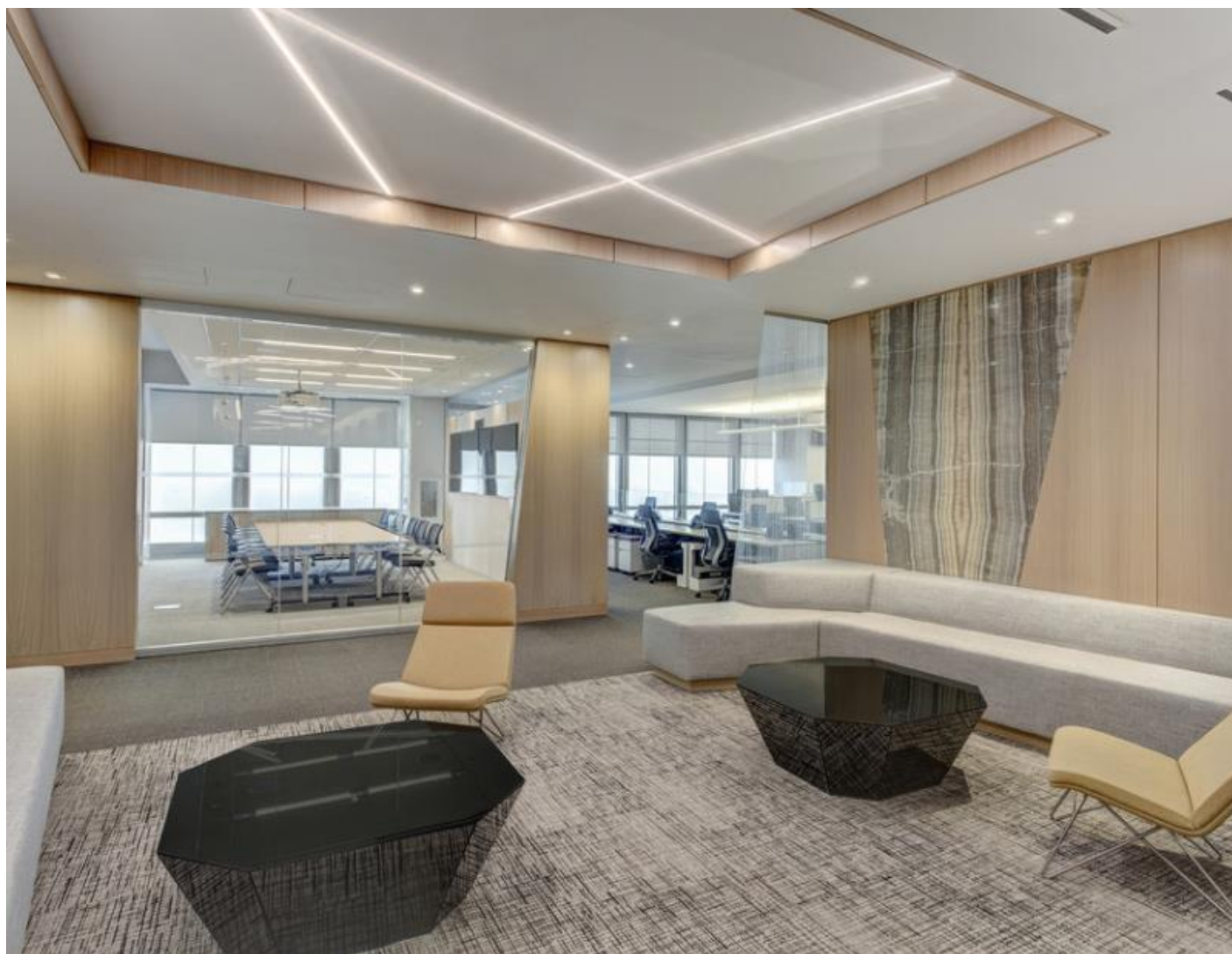





Frame Dimensions:	Standard track horizontal bottom & top rails (nominal) 3.43" x 2.25" 1.75" vertical profiles (typical) Silence Low Profile horizontal bottom rail 3.43" x 1.13" Silence Low Profile horizontal top rail 3.43" x 1.75"
Panel Options:	Double-Glazed, Single Offset-Glazed, Solid
Maximum Glass Size:	10'H, 42"W (other sizes available, project specific)
Leveling Tolerance:	Standard Track +/- 1/2"
Leveling Tolerance:	Low Profile +/- 1/4"
Ceiling Connection:	Soffit Grid Installation
Glazing:	1/2" Tempered and Laminated, 1/2" Low Iron, 1/2" Acid-Etched Glass, 3/8" Tempered and Laminated, Clear Polycarbonate Glazing Channel, MDF Substrate
Door Options:	Single-Glazed Frameless Sliding & Pivot, Single-Glazed Framed Sliding & Pivot, Double-Glazed Framed Sliding & Pivot, Veneer/Painted Sliding & Pivot, Pocket
Hardware:	Locking and Non-Locking Ladder Pulls, Cylindrical & Mortise Locksets, Offset Pivot Hinges, Roller Hardware
Finishes:	Polished & Anodized Aluminum, Fabric Wrapped, Melamine, Markerboard, Veneer, Powder Coat Paint (custom color available)
STC:	Double Glazed 46 - Single Glazed 36
Lead Time:	6 weeks after receipt of approved shop drawings & field measurements
Manufacturing Location:	Treviso, Italy (600 L.F. kept in stock in West Chester, PA)