



Product Overview Silence

Transwall 800.441.9255









SILENCE



Transwall

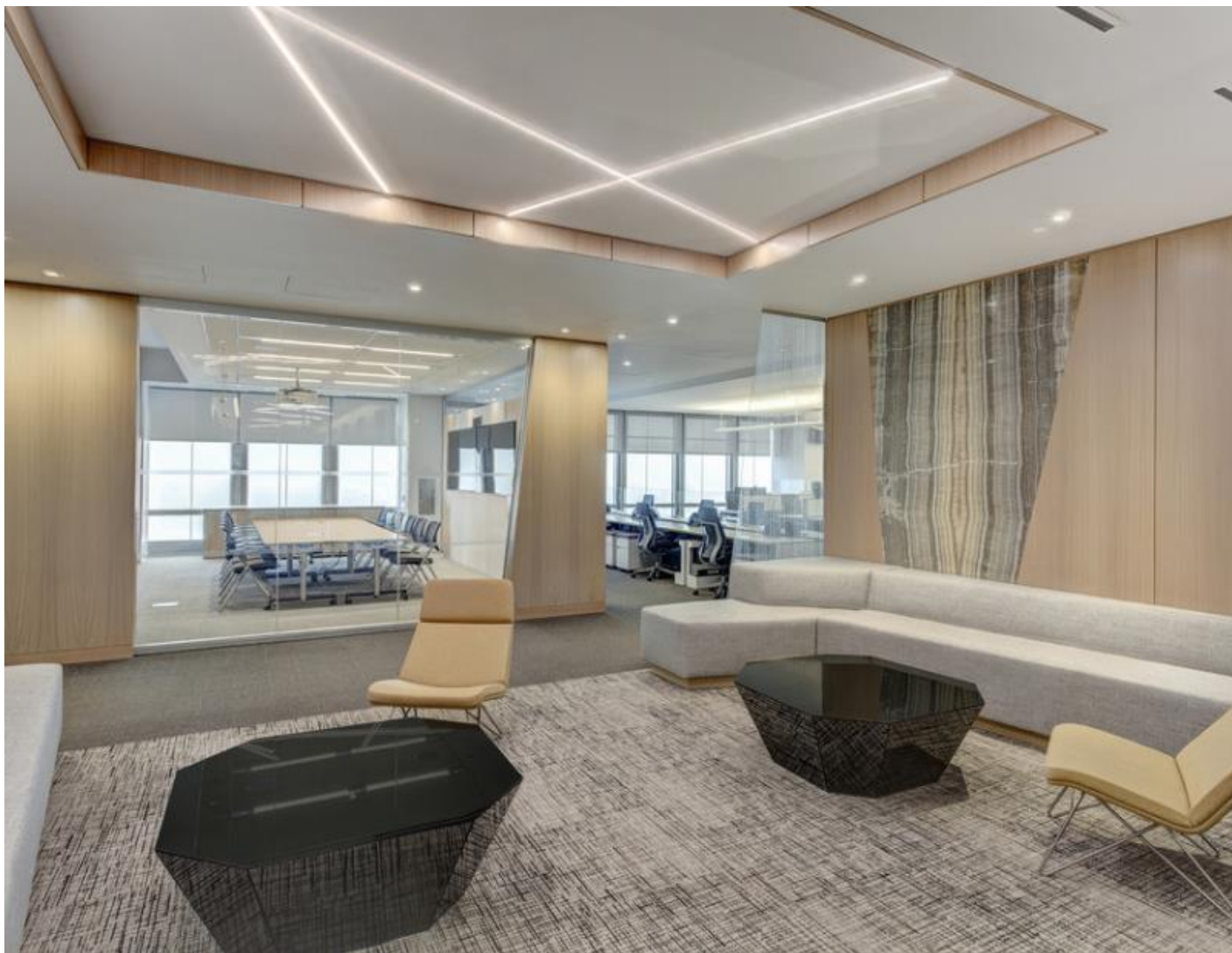





Frame Dimensions:	3.43" x 2.25" horizontal bottom and top rails (nominal) 1.75" vertical profiles (typical)
Panel Options:	Double-Glazed, Single Offset-Glazed, Solid
Maximum Glass Size:	10'H, 42"W (other sizes available, project specific)
Leveling Tolerance:	+/- 1/2"
Ceiling Connection:	Soffit Installation
Glazing:	1/2" Tempered and Laminated, 1/2" Low Iron, 1/2" Acid-Etched Glass, 3/8" Tempered and Laminated, Clear Polycarbonate Glazing Channel, MDF Substrate
Door Options:	Single-Glazed Frameless Sliding & Pivot, Single-Glazed Framed Sliding & Pivot, Double-Glazed Framed Sliding & Pivot, Veneer/Painted Sliding & Pivot, Pocket
Hardware:	Locking and Non-Locking Ladder Pulls, Cylindrical & Mortise Locksets, Offset Pivot Hinges, Roller Hardware
Finishes:	Polished & Anodized Aluminum, Fabric Wrapped, Melamine, Markerboard, Veneer, Powder Coat Paint (can do any custom color)
STC:	46
Lead Time:	10 weeks after receipt of approved shop drawings & field measurements
Manufacturing Location:	Treviso, Italy (500 LF kept in stock in West Chester, PA)